



# **TENDER DOCUMENT**

**FOR**

**VARIOUS CIVIL WORKS FOR DGPS STATION AT  
SILGHAT, ASSAM" ON NATIONAL WATERWAYS NO-2  
RIVER BRAHMAPUTRA INCLUDING BOUNDARY WALL,  
FOUNDATION OF WHIP ANTENNA, COIL HUT, LAND  
DEVELOPMENT, DRAINAGE, ETC.**

**TENDER No. 30A/2010-11**

**INLAND WATERWAYS AUTHORITY OF INDIA**

(Ministry of Shipping, Govt. of India)

Head Office: A-13, Sector – 1, Noida-201 301 (U.P.)

&

**INLAND WATERWAYS AUTHORITY OF INDIA**

(Ministry of Shipping, Govt. Of India)

Pandu Port Complex, Pandu

Guwahati-781012 (Assam).

Telephone Nos. 0361-2570055, 2570099



## INLAND WATERWAYS AUTHORITY OF INDIA

(Ministry of Shipping, Govt. of India)  
Pandu Port Complex, Pandu, Guwahati-781012 (Assam).  
Telephone Nos. 0361-2570055, 2570099

No:

Date:

To,

**Sub: Tender document for various civil works for DGPS Station at Silghat, Assam” on National Waterways No-2, river Brahmaputra including boundary wall, foundation of whip antenna, coil hut, land development, drainage, etc.**

Ref: Your letter no. \_\_\_\_\_

Dated: \_\_\_\_\_

Sir,

With reference to your letter cited on the above-mentioned subject, please find enclosed herewith one set of tender document for the subject work. You are requested to go through the terms and conditions carefully and also visit the site to familiarize and submit your tender as per procedure explained therein.

The last date for receipt of tender is 18.04.2011 up to 15.00 hours at the O/O the Director, IWAI, Pandu Port Complex, Pandu, Guwahati -781 012(ASSAM).

Issuance of tender document will not construe that such bidders are automatically considered qualified.

Yours faithfully,

**Director**



## INLAND WATERWAYS AUTHORITY OF INDIA

(Ministry of Shipping, Govt. of India)

Pandu Port Complex

Pandu, Guwahati – 781 012 (ASSAM).

Telephone Nos. 0361-2570055, 2570099,

### NOTICE INVITING TENDER No.IWAI/GHY/3(41)/30/2010-11

1. **Name of Work** : Tender document for Tender document for various civil works for DGPS Station at Silghat, Assam” on National Waterways No-2, river Brahmaputra including boundary wall, foundation of whip antenna, coil hut, land development, drainage, etc.
2. **Estimated Cost of the work and EMD requirement are as under:**

Sl. No	Name of Works	Estimated Cost (Rs. in Lakh)	EMD (Rs )
1.	Tender document for various civil works for DGPS Station at Silghat, Assam” on National Waterways No-2, river Brahmaputra including boundary wall, foundation of whip antenna, coil hut, land development, drainage, etc	31.07	62,200/-

3. **Date of sale of tenders** : From 21-03-2011 to 13.04-2011.
4. **Last date of submission of tender** : 18-04-2011 up to 15.00 hours
5. **Date of opening of technical bid of the tender:** 18-04-2011 at 15.30 hours
6. Tender document can be purchased by paying Rs. 1,000/- (Rupees one thousand only) in the form of non refundable demand draft in favour of ‘IWAI FUND’ payable at Guwahati at any nationalized/ schedule bank from the office of the Director, IWAI, Pandu Port Complex, Pandu, Guwahati – 781012 on any working day Monday to Friday/ Saturday during office hours between 10.00 hrs. to 17.00 hrs.
7. The tender document can also be downloaded from the IWAI’s website “www.iwai.nic.in” Bidders submitting the downloaded version of tender document are required to submit **Rs. 1,000/- (Rupees one thousand only)** i.e. an amount equal to the cost of tender document along with tender in the form of non refundable demand draft made in favour of ‘IWAI FUND’ payable at Guwahati at any nationalized/ schedule bank. A signed declaration stating that no alteration has been made in any form in the downloaded tender document is to be enclosed with the tender by the bidder for downloaded tenders.

For further details please contact IWAI office or visit website at ‘www.iwai.nic.in’

(Director)

# C O N T E N T S

**NOTICE INVITING TENDER**

**TENDER FORM**

**WARRANTY FORM**

**PART-I INFORMATION AND INSTRUCTIONS FOR TENDERERS**

**PART-II GENERAL CONDITIONS OF CONTRACT**

**PART-III TECHNICAL AND SPECIAL CONDITIONS**

**PART – IV BILL OF QUANTITY**

**AGREEMENT FORMAT : ANNEXURE - I**

**BANK GUARANTEE FORMAT : ANNEXURE – II**

**E – PAYMENT FORMAT : ANNEXURE - III**



# INLAND WATERWAYS AUTHORITY OF INDIA

(Ministry of Shipping, Govt. of India)

Pandu Port Complex, Pandu

Guwahati-781001 (Assam).

Telephone Nos. 0361-2570055, 2570099

## NOTICE INVITING TENDER

**Name of Work:** Tender document for various civil works for DGPS Station at Silghat, Assam” on National Waterways No-2, river Brahmaputra including boundary wall, foundation for whip antenna, coil hut, land development, drainage, etc.

1. Inland Waterways Authority of India (IWAI) invites sealed tenders in two cover system (Cover I - Technical bid and Cover II - Financial Bid) from experienced contractors for the work of “Various civil works for DGPS Station at Silghat, Assam” on National Waterways No-2, river Brahmaputra including boundary wall, foundation for whip antenna, coil hut, land development, drainage, etc”.
2. The sealed tenders should super scribe the words “Various civil works for DGPS Station at Silghat, Assam” on National Waterways No-2, river Brahmaputra including boundary wall, foundation for whip antenna, coil hut, land development, drainage, etc”.
3. Estimated Cost of the work and other details are as under:

Sl. No	Location of the work	Quantity	Estimated Cost (Rs. in Lakh)	EMD (in Rupees)
1.	Silghat, Assam.	As per Bill of Quantity	31.07	62,200

### TERMS & CONDITIONS: -

4. Interested bidders may obtain non-transferable bid document by submitting non-refundable demand draft for Rs. 1000/- (Rupees one thousand only) drawn in favour of “IWAI-FUND” payable at Guwahati. Tender document will be available for sale from 21.03.2011 to 13.04.2011 between 10.00 hours to 17:30 hours (IST) on any working day from Monday to Saturday from the office of the Director, Inland Waterways Authority of India, Pandu Port complex, Pandu, Guwahati-781012(Assam).
5. The tender document can also be downloaded from the IWAI’s website “www.iwai.nic.in”. Bidders submitting the downloaded version of tender document is required to submit Rs. 1000/- (Rupees one thousand only) i.e. an amount equal to the cost of tender document along with tender in the form of demand draft made in favour of ‘IWAI-FUND’ payable at **GUWAHATI** at any nationalized/ schedule bank. A signed declaration stating that no alteration has been made in

any form in the downloaded tender document is to be enclosed with the tender by the bidder for downloaded tenders.

6. The tenderer shall meet the following pre-qualification criteria:

- i. The tenderer shall be registered with Central Public Works Department, Railways, MES and State PWD/ Irrigation Department or non-registered contractors having experience of working with IWAI.
- ii. Tenderer shall have Permanent Account Number issued by Income Tax Deptt.
- iii. Average annual financial turnover during last three years ending 31<sup>st</sup> March of the previous financial year, should be at least 30% of the cost. Experience of having successfully completed similar works like **TERMINAL WORKS /R.C WORKS/BUILDING WORKS** during last 7 years ending last day of month previous to the one in which this tender is invited should be either of following:

- (a) Three similar works costing not less than 40% of the estimated cost; **or**
- (b) Two similar works costing not less than 50% of the estimated cost; **or**
- (c) One similar work completed not less than 80% of the estimated cost

iv. Latest certificate of solvency from nationalized / scheduled Bank included in the second schedule of the RBI Act for not less than the value indicated below:

Sl. No	Location of the work	Bank solvency required (Rs. in Lakhs)
1.	Silghat, Assam.	9.32

- v. The tenderer shall agree to the terms & conditions of the tender and return the tender duly signed in each page for agreeing the same.
- vi. The tenderer shall submit required Earnest Money Deposit in the form of demand draft. Any / all submissions made without the earnest money and/or after the date mentioned hereinafter in clause 6 shall be deemed to be rejected.
- vii. The preference shall be given to the bidder having specific experience in civil works on construction & repairing of buildings etc.

7. The complete bid as per the tender document should reach the office of **Director, IWAI, Pandu Port Complex, Pandu, Guwahati** latest by 15.00 hrs. on 18.04.2011. The technical bid will be opened on the same day at 15.30 hrs. in the presence of intending bidders.

8. **IWAI** reserve the right to accept or reject any or all tenders without assigning any reason and no correspondence shall be entertained in this regard.

- sd -

**Director**

**FORM OF TENDER**

To,

THE DIRECTOR,  
INLAND WATERWAYS AUTHORITY OF INDIA,  
PANDU PORT COMPLEX, PANDU,  
GUWAHATI-781012(ASSAM).

**Name of Work: Tender document for “various civil works for DGPS Station at Silghat, Assam on National Waterways No-2, river Brahmaputra including boundary wall, foundation for whip antenna, coil hut, land development, drainage, etc”.**

Sir,

1. Having visited the site and examined the information and instructions for submission of tender, general conditions of contract, Special Condition of contracts, Technical, General and Detailed specification, Schedules and Bill of Quantities, agreement and bank guarantee forms, etc for the above named works, I/ We hereby tender for execution of the works referred to in the tender documents in conformity with the said Conditions of Contract, Specifications, Schedule of quantities for the sum as stated in Bill of quantities of this tender Document or such other sum as may be ascertained in accordance with the said conditions of contract.

2. I/ We undertake to complete and Deliver the whole of the works comprised in the Contract within the time as stated in the tender and also in accordance in all respects with the specifications, designs, drawings and instructions as mentioned in the tender documents.

3. I am tendering for the works mentioned in the table below and submitting the EMD in the form of demand draft in favour of “IWAI FUND” payable at **Guwahati** on Nationalized / schedule bank as per the details given therein:

<b>Sl. No</b>	<b>Location of the work</b>	<b>Demand draft No. &amp; Date</b>	<b>EMD (Rs.)</b>	<b>Details of Bank (Name of Bank, Branch and address)</b>
1.	<b>Silghat, Assam.</b>			

4. I/ We agree to abide by this tender. I/ We agree to keep the tender open for a period of 90 days from the date of opening of price bids or extension thereto as required by the IWAI and not to make any modifications in its terms and conditions.

5. I/ We agree, if I/ we fail to keep the validity of the tender open as aforesaid or I/ we make any modifications in the terms and conditions of my/ our tender if I/ We fail to commence the execution of the works as above, I/ We shall become liable for forfeiture of my/ our Earnest money, as aforesaid and IWAI shall without any prejudice to an other right or remedy, be at the liberty to forfeit the said Earnest Money absolutely otherwise the said earnest money shall be retained by IWAI towards part of security deposit to execute all the works referred to in the tender documents upon the terms and conditions contained or referred to therein and to carry out such deviations as may be ordered. Should this tender

be accepted, I/ We agree to abide by and fulfill all the terms and conditions and provisions of this tender. No interest is payable on earnest money deposit and/ or security deposit.

6. I/ We have independently considered the amount of Liquidated Damages shown in the tender hereto and agree that it represents a fair estimate of the loss likely to be suffered by IWAI in the event of works not being completed in time.

7. If this tender is accepted, I/We undertake to enter into execute at my/ our cost when called upon by the employer to do so, a contract agreement in the prescribed form. Unless and until a formal Agreement is prepared and executed this tender together with your written acceptance thereto shall constitute a binding contract.

8. If my/ our tender is accepted, I/We am/are to be jointly and severally responsible for the due performance of the Contract. I/We also declare that the firm has not been banned or blacklisted by any Govt. or its department or any Quasi Govt. agency or Public Sector Undertaking.

9. I/ We understand that you are not bound to accept the lowest or any Tender you may receive and may reject all or any tender without assigning any reason.

10. I/We certify that the tender submitted by me, us is strictly in accordance with the terms, conditions, specifications etc. as contained in the tender document, and it is further certified that it does not contain any deviation to the aforesaid documents.

11. I/We certify that I/we am/are familiar with all general and special laws, Acts, Ordinance, Rules & Regulation of the Municipalities, District, State and Central Government that may affect the work, its performance or personnel employed therein or environment.

12. It is certified that all information given in the tender is true and nothing has been concealed/ distorted. If at any time, it is found to have concealed/ distorted any material as mentioned above I/we am/are agreeable for summarily termination of contract by IWAI.

Date .....

Signature .....

Name .....

Designation .....

duly authorized to sign & submit tender for an on behalf of  
(Name and address of firm)

M/s .....

Telephone nos.....FAX No.....

Witness :

Signature.....

Name : .....

Occupation .....

Address .....

Telephone nos.

## WARRANTY FORM

M/s \_\_\_\_\_

\_\_\_\_\_ having its registered office at \_\_\_\_\_ (hereinafter referred to as the contractor) having carefully studied all the documents, specifications, designs, drawings etc pertaining to the contract for works required for the work of \_\_\_\_\_

and the local and site conditions and having under taken to execute the said works:

### **DO HEREBY WARRANT THAT :**

1. The contractor is familiar with all the requirements of the contract.
2. The Contractor has investigated the site and satisfied himself regarding the character of the work and local conditions that may affect the work or its performance.
3. The contractor is satisfied that the work can be performed and completed as required in the contract.
4. The contractor accepts all risks directly or indirectly, connected with the performance of the contract.
5. The contractor has no collusion with other contractors, with any of the men of the Engineer-in-Charge or with any other person in Authority to execute the said works according to the terms and conditions of the said contract.
6. The contractor has not been influenced by any statement or promise of the Authority or Engineer-in-Charge but only by the contract documents.
7. The Contractor is financially solvent.
8. The Contractor is experienced and competent to perform the contract to satisfaction of the Engineer-in-Charge.
9. The Statement submitted by the contractor is true.
10. The contractor is familiar with all general and special laws , Acts, Ordinance, Rules & Regulation of the Municipalities, District, State and Central Government that may affect the work, its performance or personnel employed therein or environment.

Date:

For and on behalf of the Contractor.

Signature : \_\_\_\_\_

Name : \_\_\_\_\_

Stamp : \_\_\_\_\_

# **PART – I**

## **INFORMATION AND INSTRUCTIONS FOR TENDERERS**

### **CONTENTS**

- 1. GENERAL**
- 2. ELIGIBILITY**
- 3. BIDDING PROCEDURE**
- 4. LAST DATE AND TIME FOR SUBMISSION AND OPENING**
- 5. EARNEST MONEY DEPOSIT**
- 6. CONTRACT**
- 7. VALIDITY OF OFFER**
- 8. DETAILS OF OFFER**
- 9. ANNEXURE 1.1**

## **PART - I**

### **INFORMATION AND INSTRUCTIONS FOR TENDERERS**

#### **1. GENERAL**

- 1.1** The Details of work to be carried out and its scope are given in the "Technical Specifications" of these documents, which also indicate a brief description of the work to be executed. The tenderers are advised to study the same carefully before tendering and they shall be deemed to have fully acquainted themselves with the same.
- 1.2** The tenderers in their own interest, are also advised to inspect and examine the site and its surrounding and satisfy themselves, before submitting their tenders, in respect of the site conditions including but not restricting to the following which may influence or affect the work or cost thereof under the contract.
- a) Site conditions including access to the site, existing and required roads and other means of transport/communication for use by him in connection with the work;
  - b) Requirement and availability of land and other facilities for his enabling work, colonies, stores and workshops etc.;
  - c) Ground conditions including those bearing upon transportation, disposal, handling and storage of materials required for the work or obtained there from;
  - d) Source of extent of availability of suitable materials including water etc. and labour (skilled and unskilled), required for work and Laws and Regulations governing their use and employment;
  - e) Geological, meteorological, topographical, hydrological, morphological and other general features of the site and its surroundings as are pertaining to and needed for the performance of the work;
  - f) The type of equipment and facilities needed, preliminary to / for and in the performance of the work and;
  - g) All other information pertaining to and needed for the work including information as to the risks, contingencies and other circumstances which may influence or affect the work or the cost thereof under this contract.
- 1.3** The tenderers shall note that information, if any in regard to the work site and local conditions as contained in these tender documents except for the material agreed to be supplied by the Authority, has been given merely to assist the tenderers and is not warranted to be complete.
- 1.4** The tenderers shall note and bear in mind that the Authority shall bear no responsibility for the lack of acquaintance with site condition, systems etc. or any information relating thereto, on their part. The consequence of the lack of any knowledge aforesaid, on the part of the tenderers shall be at their risk and cost and no charges or claims whatsoever consequent upon the lack of any information, knowledge or understanding shall be entertained or payable by the Authority.

**1.5** The tender shall be submitted in the prescribed form and the same shall be signed in all pages and in all copies properly as laid down hereunder.

- a) If the tender is submitted by an individual or a proprietary firm, it shall be signed by the proprietor above his full name and full name of his firm with its current business address.
- b) If the tender is submitted by a firm in partnership, it shall be signed by all the partners of the firm above their full names and current business address(s), or by a partner holding the power of attorney for the firm by signing the tender in which case a certified copy of the power of attorney shall accompany the tender. A certified copy of the partnership deed and current business address of all the partners of the firm shall also accompany the tenders.
- c) If the tender is submitted by a limited company or limited corporation, it shall be signed by a duly authorized person holding the power of attorney for signing the tender in which case a certified copy of the power of attorney shall accompany the tender. Such limited company or corporation may be required to furnish satisfactory evidence of its existence before the contract is awarded.
- d) If the tender is submitted by a group of firms, the sponsoring firm shall submit complete information pertaining to each firm in the group and state along with the bid as to which of the firms shall have the responsibility for tendering and for completion of the contract documents and furnish evidence admissible in law in respect of the authority assigned to such firm on behalf of the group of firms for tendering and for completion of the contract documents. The full information and satisfactory evidence pertaining to the participation of each member of the group of firms in the tender shall be furnished along with the tender.
- e) All witnesses and sureties shall be persons of status and their full names, occupations and address shall be stated below their signatures. All signatures affixed on each page in the tender will be dated.
- f) A tenderer or tenderers who himself / themselves has /have tendered for the same works shall not be a witness. Failure to observe this condition shall render the tender invalid and liable to rejection.

**1.6** For furnishing information regarding the tenderers experience and financial capabilities Annexure – 1.1 provided with the tender document shall be used. Incomplete or false information if any provided by the tenderers in the Annexure shall be liable to rejection of the tender and forfeiture of EMD.

The tenderer shall furnish with his tender the following:----

- a. Bio-data of technical and supervisory personnel to be deployed for this work. (The contractor shall note that any change in the personnel proposed shall be permitted, only in case, the Authority approves the alternative personnel proposed by the contractor)
- b. Relevant information on the capacity; financial resources and experience of the Tenderer.

**1.7** a. Earnest money Deposit @2.0% of the estimated value of the total works must accompany with the tender. This deposit shall be in favour of Inland Waterways Authority of India,

Fund in the form of demand draft on any Nationalized Bank of India payable at Guwahati.

- b. Tenders not accompanied by Earnest Money deposit shall be rejected.
- c. If during the tender validity period, the tenderer withdraws his tender or makes any modifications in terms and conditions that are not acceptable to IWAI the earnest money deposit shall be forfeited.
- d. The Earnest Money Deposit shall be refunded to the unsuccessful tenderers within one month after the date of award of the work to the successful tenderer.
- e. Interest shall not be paid on Earnest Money Deposit.
- f. In the case of a successful tenderer, the E.M.D. shall be forfeited on the following grounds:
  - (i) If the tenderer fails to sign the contract or to furnish the security deposit in accordance with clause 3 of General Conditions of contract on receipt of award of work. Or
  - (ii) If the tenderer fails to commence the work as specified in the tender in prescribed time or abandons the work before its completion.

**1.8** The rates shall be written both in words and in figures. Tenderer shall also show the total of each item, the total of each schedule and the grand total of whole contract. Corrections, if any, shall be made by crossing out, initialing, dating and rewriting. In case of conflict between the figures and words in the rates, the later shall prevail.

**1.9** The Authority shall have the right of rejecting all or any of the tenders and shall not be bound to accept the lowest or any tender or to give any reasons for their decision.

**1.10** The Tender Evaluation Committee (TEC) shall open the tenders in the presence of tenderers who may be present at the time. If any of the tenderer or his agent is not present at the time of opening of tender, the TEC shall, on opening of tenders of the absentee tenderer, prepare a statement of the attested and unattested corrections in the tender over his signature. Such a list shall then be binding on the absentee tenderer.

**1.11** The tenderers shall not be entitled during the period of validity of their offer, without the written consent of the Authority to revoke or withdraw their tenders or vary in any respect the tender given or any term thereof. In case of a tenderer revoking or withdrawing his tender or varying any terms in regard thereof without the consent of the Authority in writing, his earnest money paid along with the tender shall be forfeited.

**1.12** The "Notice Inviting Tender" and this "Information and Instruction for tenderers" shall form part of the Tender Documents.

**1.13 Banned or Blacklisted Contractors**

The bidder shall give a declaration that they have not been banned or black-listed by any Govt. or Quasi Govt. Agency or Public Sector Undertaking (PSU).

If a bidder has been banned by any Govt. or Quasi Govt. Agency or PSU, this fact must be clearly stated and it may not necessarily be a cause of disqualifying the firm. If this declaration is not given, the bid shall be rejected as non-responsive.

## **2. ELIGIBILITY**

- 2.1 Tender shall be considered only from experienced contractors registered in appropriate class with CPWD, Railways, MES or any other Govt. departments for respective works having experience for similar work or non registered contractors having experience of working with IWAI.
- 2.2 Tendering forms must have adequate experience in similar works using dependable equipments and trained manpower for working.
- 2.3 The tenderer shall be Income Tax Payee & shall submit copy of his PAN number
- 2.4 The forms must submit details of relevant experience in the format enclosed which will form the basis for acceptance of their bids (refer Annexure 1.1).

## **3. BIDDING PROCEDURE**

- 3.1 Bids will be in two separate cover system – Technical bid and Price bid.

Technical bids should include the following :---

- a) Details of the equipment proposed to be deployed on the job.
- b) Details of work experience in similar jobs.
- c) Details of manpower to be deployed.
- d) Bank draft \_\_\_\_\_ as mentioned in the NIT for the said works towards EMD in favour of IWAI FUND payable at Guwahati
- e) Any other deviations or conditions the contractor may want, which in his opinion will be more effective and conducive to smoother completion. This should be spelt out clear in a separate letter.

Price bids will contain Schedules A to I (BOQ) price and rates only. NO SPECIAL CONDITIONS OR ANY OTHER STATEMENT OTHER THAN PRICES SHALL BE ENCLOSED IN PRICE BID.

- 3.2 Technical bid and price bid should be put in separate envelopes super scribed accordingly, clearly and sealed properly. The address of tendering firm, name of tenderer and address should also be written/typed clearly on each envelope.
- 3.3 These two envelopes should be placed in a cloth lined sealed envelope super scribed “**Tender document for “various civil works for DGPS Station at Silghat, Assam on National Waterways No-2 (River Brahmaputra) including boundary wall, foundation for whip antenna, coil hut, land development, drainage, etc”** with closing date and addressed to:

**The Director  
I.W.A.I.  
Pandu Port Complex, Pandu  
Guwahati-781012**

- 3.4 The envelopes may be sent by registered post or hand delivered or by courier to reach before closing time. Tenders received after closing time and date will not be accepted.
- 3.5 Tender papers must be filled complete in all respects and free from any ambiguity and should contain all requisite information.
- 3.6 The document should comply with technical and commercial requirements and objectives.
- 3.7 The original tender document duly signed in every page by authorized signatory should be returned with Technical bid.

**4. LAST DATE AND TIME FOR SUBMISSION AND OPENING**

The tender shall be received up to 15.00 hrs. on 18-04-2011 and shall be opened at 15.30 hrs. on the same day in the presence of authorized representatives of the tenderers who would like to be present at the time of opening. No late tenders shall be considered.

**5. EARNEST MONEY DEPOSIT**

The tender shall be accompanied with a crossed Bank Draft as specified in NIT/as mentioned in the NIT for respective places, drawn on any Nationalised Bank in favour of "INLAND WATERWAYS AUTHORITY OF INDIA FUND" payable at Guwahati.

**6. CONTRACT**

The successful tenderer shall be required to execute a contract agreement with Inland Waterways Authority of India (IWAI) in the format enclosed with tender document.

**7. VALIDITY OF PRICES**

The tenderer should quote the rate for various items of work in prescribed schedule. The rates quoted should be firm and should be kept valid for consideration for atleast 120 days from the date of closing of the tender.

**8. DETAILS OF OFFER**

The tenderer should indicate clearly in Annexure 1.2 list of plant, machinery and equipment and in Annexure 1.3 bar chart of work to be executed.

IWAI reserves the right to sublet the contract to one or more parties without assigning any reason thereof.

IWAI has the right to reject all or any of the tenders and will not be found to accept the lowest or any other tender or to give any reason for such decision.

**9. COMPLETION TIME OF WORKS -:**

The all specified works for construction of various civil works like foundation of whip antenna, coil hut, land development, drainage, boundary wall etc. for DGPS station at Silghat to be completed within 120 days from the date of issue of work order.

**QUESTIONNAIRE**

**DETAILED INFORMATION ON CONTRACTOR'S EXPERIENCE  
AND FINANCIAL CAPABILITY**

1. NAME OF THE BIDDER
2. FULL ADDRESS WITH PIN CODE,  
TELEPHONE NO. AND FAX NO.
3. LEGAL STATUS, WHETHER  
INDIVIDUAL, PROPRIETARY OR  
PARTNERSHIP FIRM OR  
INCORPORATED BODY ETC.  
ALONG WITH DOCUMENTARY PROOF.
4. REGISTRATION STATUS WITH  
CENTRAL/STATE GOVERNMENT  
ETC. ALONG WITH DOCUMENTARY PROOF.
5. DETAILS OF MANPOWER,  
EQUIPMENT AND FACILITIES  
AVAILABLE WITH THE FIRM AND  
THEIR PRESENT DEPLOYMENT
6. DETAILS OF SIMILAR WORKS  
UNDERTAKEN DURING LAST  
SEVEN YEARS (DOCUMENTARY PROOF)
7. CURRENT INCOME TAX  
CLEARANCE CERTIFICATE  
(DOCUMENTARY PROOF)
8. BANK SOLVENCY CERTIFICATE  
(DOCUMENTARY PROOF ON  
FORMAT ENCLOSED)
9. FINANCIAL CAPABILITIES OF FIRM  
(ENCLOSE ANNUAL REPORT FOR LAST  
THREE YEARS)
10. ANY OTHER RELEVANT INFORMATION/  
DOCUMENT PERTAINING TO  
QUALIFICATION BEING  
SUBMITTED/ ENCLOSED BY THE FIRM

NOTE: IN CASE SPACE PROVIDED IS INADEQUATE, THE INFORMATION CALLED FOR  
MAY BE GIVEN ON SEPARATE SHEET.

**NAME OF THE CONTRACTOR**

SIGNATURE WITH  
DATE & SEAL

## **PART-II**

### **GENERAL CONDITIONS OF CONTRACT**

#### **CONTENTS**

CLAUSE-1	: DEFINITIONS
CLAUSE-2	: INTERPRETATIONS
CLAUSE-3	: SECURITY DEPOSIT FOR PERFORMANCE
CLAUSE-4	: REFUND OF SECURITY DEPOSIT
CLAUSE-5	: SUFFICIENCY OF TENDER
CLAUSE-6	: CONTRACT DOCUMENTS
CLAUSE-7	: DISCREPANCIES AND ADJUSTMENT OF ERRORS
CLAUSE-8	: DUTIES AND POWERS OF ENGINEER-IN-CHARGE'S REPRESENTATIVE
CLAUSE-9	: ASSIGNMENT AND SUB-LETTING
CLAUSE-10	: FACILITIES TO OTHER CONTRACTORS
CLAUSE-11	: CHANGE IN CONSTITUTION
CLAUSE-12	: COMMENCEMENT OF WORK
CLAUSE-13	: WORKS TO BE CARRIED OUT IN ACCORDANCE WITH SPECIFICATION DRAWINGS AND ORDERS ETC.
CLAUSE-14	: SETTING OUT THE WORKS
CLAUSE-15	: URGENT WORKS
CLAUSE-16	: DEVIATIONS
CLAUSE-17	: CONTRACTORS SUPERVISION
CLAUSE-18	: INSTRUCTION AND NOTICE
CLAUSE-19	: PLANT AND EQUIPMENT
CLAUSE-20	: PATENT RIGHTS
CLAUSE-21	: MATERIALS
CLAUSE-22	: LAWS GOVERNING THE CONTRACT
CLAUSE-23	: WATCHING AND LIGHTING
CLAUSE-24	: WORK DURING NIGHT OR ON SUNDAYS AND HOLIDAYS
CLAUSE-25	: LABOUR
CLAUSE-26	: MATERIALS OBTAINED FROM EXCAVATION AND TREASURE TROVE, FOSSILS ETC.
CLAUSE-27	: FORCE MAJEURE
CLAUSE-28	: LIABILITY FOR DAMAGE, DEFECTS OR IMPERFECTIONS & RECTIFICATION THEREOF
CLAUSE-29	: CONTRACTOR'S LIABILITY AND INSURANCE
CLAUSE-30	: SUSPENSION OF WORKS
CLAUSE-31	: FORE CLOSURE OF CONTRACT IN FULL OR IN PART DUE TO ABANDONMENT OR REDUCTION IN SCOPE OF WORK
CLAUSE-32	: TERMINATION OF CONTRACT ON DEATH
CLAUSE-33	: CORRUPT PRACTICE & TERMINATION OF CONTRACT IN FULL OR IN PART
CLAUSE-34	: COMPLETION TIME AND EXTENSIONS
CLAUSE-35	: COMPENSATION FOR DELAY
CLAUSE-36	: LIQUIDATED DAMAGES
CLAUSE-37	: INSPECTION AND APPROVAL
CLAUSE-38	: COMPLETION CERTIFICATE
CLAUSE-39	: MEASUREMENTS
CLAUSE-40	: PAYMENT ON ACCOUNT
CLAUSE-41	: TAXES, DUTIES AND LEVIES ETC
CLAUSE-42	: TAX DEDUCTION AT SOURCE
CLAUSE-43	: PAYMENT ON FINAL BILL
CLAUSE-44	: OVER PAYMENTS AND UNDER PAYMENTS
CLAUSE-45	: CONTRACT MATTERS TO BE TREATED AS CONFIDENTIAL
CLAUSE-46	: FINALITY CLAUSE
CLAUSE-47	: SUM PAYABLE BY WAY OF COMPENSATION TO BE CONSIDERED IS REASONABLE WITHOUT PREFERENCE TO ACTUAL LOSS
CLAUSE-48	: ARBITRATION
CLAUSE-49	: VALIDITY OF TERMS & CONDITIONS

## PART - II

### GENERAL CONDITIONS OF CONTRACT

#### CLAUSE - 1: DEFINITIONS

In the contract, the following words & expressions shall, unless context otherwise requires, have the meaning thereby respectively assigned to them:

- i) **Contract:** means the documents forming the tender and acceptance thereof and the formal agreement executed between the competent authority on behalf of the Chairman, Inland Waterways Authority of India and the contractor, together within the documents referred to therein including these conditions, the specifications, designs, drawings and instructions issued from time to time by the Engineer-in-charge and all these documents taken together shall be deemed to form one contract and shall be complementary to one another
- ii) **Contract sum;** means the amount arrived at by multiplying the quantities shown in the schedule of quantities and price by the respective item rates as allowed.
- iii) **Contractor:** means the successful tenderer who is awarded the contract to perform the work covered under this tender documents and shall be deemed to include the contractor's successors, executors, representatives or assign approved by the Engineer-in-charge.
- iv) **Employer** means the Chairman, Inland Waterways Authority of India and his successors.
- v) **IWAI/ Authority/ Department/ Owner** shall mean the Inland Waterways Authority of India, which invites tenders on behalf of the Chairman, IWAI and includes therein-legal representatives, successors and assigns.
- vi) **Engineer-In-Charge (EIC)** means the Engineer officer authorised to direct, supervise and be In-charge of the works for the purpose of this contract who shall supervise and be in charge of the work.
- vii) **Engineer-in-charge representative** shall mean any officer of the Authority nominated by the Engineer-in-charge for day to day supervision, checking, taking measurement, checking bills, ensuring quality control, inspecting works and other related works for completion of the project.
- viii) **Chairman:** means Chairman of Inland Waterways Authority of India.
- ix) **Chief Engineer:** means the Chief Engineer of the Authority.
- x) **Director** means the Director of the Authority, as the case may be.
- xi) **Deputy Director** means the Deputy Director of the Authority, as the case may be.
- xii) **Assistant Director** means the Asstt. Director of the Authority, as the case may be.

- xiii) **Work Order** means a letter from the Authority conveying the acceptance of the tender/offer subject to such reservations as may have been stated therein.
- xiv) **Day** : means a calendar day beginning and ending at mid-night.
- xv) **Week** : means seven consecutive calendar days
- xvi) **Month** : means the one Calendar month.
- xvii) **Site** means the waterway and / or other places through which the works are to be executed.
- xviii) **Vessel** : means the vessel/craft belonging to the Contractor for carrying out the work.
- xix) **Drawings** : means the drawings referred to in the specifications and / or appended with the tender document, any modifications of such drawings approved in writing by the Engineer-in-Charge and shall also include drawings issued for actual execution of the work time to time by the Engineer-in-Charge.
- xx) **Urgent Works**: means any urgent nature which in the opinion of the Engineer-In-Charge become necessary at the time of execution and / or during the progress of work to obviate any risk or accident or failure or to obviate any risk of damage to the vessel structure, or required to accelerate the progress of work or which becomes necessary for security or for any other reason the Engineer-in-Charge may deem expedient.
- xxi) **Work/ works**: means work / works to be executed in accordance with the contract.
- xxii) Schedules referred to in these conditions shall mean the relevant schedules annexed to the tender papers or the standard schedule of rates of the govt. mentioned with the amendments thereto issued up to the date of receipt of the tender.
- xxiii) District specifications means the specifications followed by the State Government in the area where the work is to be executed.
- xxiv) Tendered value means the value of the entire work as stipulated in the letter of award.

## **CLAUSE – 2: INTERPRETATIONS**

- 2.1 Words imparting the singular only shall also include the plural; he includes she and vice-versa unless this is repugnant to the context.
- 2.2 Heading and marginal notes in these General Conditions shall not be deemed to form part thereof or be taken into consideration in the interpretation of construction thereof of the contract.

## **CLAUSE – 3: PERFORMANCE GURANTEE & SECURITY DEPOSIT**

- 3.1 **PERFORMANCE GURANTEE** : The contractor shall be required to deposit an amount equal to 5% of the tendered value of the work as performance guarantee in the form of either demand draft payable at any nationalized/schedule bank **OR** an irrevocable bank guarantee bond of any scheduled bank or State Bank of India in accordance with the form prescribed within 15

days of the issue of the work order. The bank guarantee shall be valid till expiry of 90 days after the end of 'Period of liability' defined in the contract document.

- 3.2 **SECURITY DEPOSIT** : A sum @ 10% of the gross amount of the bill shall be deducted from each running bill of the contractor till the sum along with sum already deposited as earnest money will amount to security deposit of 5 % of the contract value of the work. Bank guarantee will not be accepted as security deposit.
- 3.3 The contractor whose tender is accepted has to enter into an agreement with IWAI for the due fulfillment of the contract. The security amount will be accepted in form of demand draft in favour of Inland Waterways Authority of India – Fund only payable at GUWAHATI.
- 3.4 The total performance guarantee/security deposit shall remain with IWAI till defect liability period after satisfactory completion of work.
- 3.5 Interest will not be paid on security deposit or performance guarantee.
- 3.6 If the contractor having been called upon by the Engineer in charge to furnish the security fails to do so within the specified period, the EMD submitted by the contractor shall be forfeited. It shall be lawful for the Employer:
- i) To recover the amount of balance security deposit by deducting the amount from the pending bills of the contractor under this contract or any other contract with the Authority, OR
  - ii) To cancel the contract or any part thereof and to carry out the work or authorise to carry out the work/ works at the risk and cost of the contractor.
- 3.7 No claim shall lie against the authority either in respect of interest or any depreciation in value of any security.
- 3.8 The Contractor shall guarantee the execution of the terms of the Contract within stipulated period of time from the date of acceptance of the bid and in order to execute the work uniformly the contractor will ensure deployment of adequate number of equipment through out the contract period. Any damage or defect that may arise or lie undiscovered at the time of the final payment connected in anyway with the work done by him or in the workmanship, shall be rectified by the contractor at his own expenses as deemed necessary by the engineer or in default, the engineer may cause the same to be made good by other agencies and deduct expenses (of which the certificate of the Engineer shall be final) from any sums that may be then or at any time thereafter, become due to the contractor under the Contract or from the amount released by encashing the contract performance guarantee or recover otherwise from the contractor.
- 3.9 If the Contractor feels that any variation in work or in quantity of work be beneficial or necessary to fulfill the guarantees called for, he shall bring to this notice of the Engineer in charge in writing, at appropriate time but prior to the execution of the work and take written acceptance of same from the engineer before proceedings with the works.
- 3.10 From the commencement of completion of work, contractor shall take full responsibility for the care of work including all temporary works, or to any part thereof or to any temporary works

from any cause whatsoever, shall at his own cost repair and make good the same so that at completion, work shall be in good order and in conformity, in every respect, with the requirements of contract and Engineer's instruction.

- 3.11 If the contractor neglects to observe or fails to perform any of his obligations under the contract, it shall be lawful for the Employer/ EIC to forfeit either in whole or in part, the security deposit furnished by the contractor. However, if the contractor duly performs and completes the contract in all respects and presents in absolute "NO DEMAND CERTIFICATE" in the prescribed form, the IWAI shall refund the security deposit to the contractor after deduction of cost and expenses that the Authority may have incurred and other money including all losses and damages which the Authority is entitled to recover from the Contractor.
- 3.12 In case of delay in the progress of work, the Engineer- in-Charge shall issue to the contractor a memo in writing pointing out the delay in progress and calling upon the contractor to explain the causes for the delay within 3 days of receipt of the memo and 10 days from issuance of memo whichever is earlier. If the Engineer-in-Charge is not satisfied with the explanations offered, he may forfeit the security deposit and / or withhold payment of pending bills in whole or in part and/ or get the measures of rectification of progress of work accelerated to the pre-defined level at the risk and cost of the contractor.
- 3.13 All compensation or other sums of money payable by the contractor under the terms of the contract or any other contract or on any other account whatsoever, may be deducted from or paid by the sale of a sufficient part of his security or from the interest arising therefrom or from any sums which may be due or may become due to the contractor by the Authority on any account whatsoever. Also in the event of the contractor's security deposit being reduced by reasons of such deductions or sale, as aforesaid the contractor shall, within 14 days of receipt of notice of demand from the Engineer-in-Charge make good the deficit in his security deposit.

#### **CLAUSE – 4: REFUND OF SECURITY DEPOSIT**

The security deposit less any amount due shall, on demand, be returned to the contractor on the expiry of defects liability period or on payment of the amount of the final bill payable in accordance with the agreement conditions, whichever is later, provided the engineer-in-charge is satisfied that there is no demand outstanding against the contractor.

#### **CLAUSE – 5 : SUFFICIENCY OF TENDER**

- 5.1 The contractor shall be deemed to have satisfied himself before tendering as to the correctness and sufficiency of his tender for the works and of the rates quoted in the schedule of Quantities and Prices which shall (except as otherwise provided in the contract) cover all his obligations under the contract and all matters and things necessary for the proper execution and completion of the works in accordance with the provisions of the contract and its operation during execution of work.
- 5.2 The Contractor is deemed to have independently obtained all necessary information for the purpose of preparing the bid and his bid as accepted shall be deemed to have taken into account all contingencies as may arise due to such information or lack of the same.

- 5.3 The Contractor shall be deemed to have examined, visited and acquainted himself with the site and the surroundings to have satisfied himself to the nature contract and as to the nature and conditions of means of transport and communication, whether by land, to have made local independent inquires as to the soil/sub soil conditions variations thereof, storms, prevailing winds, climatic conditions and all other matter effecting the work.
- 5.4 Any neglect or omission or failure on the part of the contractor in obtaining necessary and reliable information upon the forgoing or any other matter affecting the contract shall not relieve the Contractor, of his responsibility/any risk/liability for completion of the work in strict accordance with the terms of the Contract.

#### **CLAUSE – 6 : CONTRACT DOCUMENTS**

- 6.1 The language in which the contract documents shall be drawn up shall be English and if the said documents are written in more than one languages, the language according to which the contract is to be constructed and interpreted shall be English and designated as the ‘Ruling Language’.
- 6.2 The Contractor shall be furnished free of charge certified true copy of the contract document.
- 6.3 A copy of the Contract Documents furnished to the Contractor as aforesaid shall be kept by the Contractor on the Site in good order and the same shall at all reasonable time be available for inspection and use by the Engineer-in-Charge, his representatives or by other Inspecting officers of the Authority.
- 6.4 None of these Documents shall be used by the Contractor for any purpose other than that of this contract.

#### **CLAUSE – 7 : DISCREPANCIES AND ADJUSTMENT OF ERRORS**

- 7.1 Detailed drawings shall be followed in preference to small-scale drawings and figured dimensions in preference to scaled dimensions. The case of discrepancy between the Schedule of Quantities and prices, the Specifications and/ or the drawings, the following order of precedence shall be observed : -
- (a) Description in the Schedule of Quantities and Prices.
  - (b) Relevant Specifications and Special Conditions, if any.
  - (c) Drawings.
  - (d) General Specifications.
- 7.2 The contractor shall study and compare the drawings, specifications and other relevant information given to him by the Engineer-in-Charge and shall report in writing to the Engineer-in-Charge any discrepancy and inconsistency which he notes. The decision of the Engineer-in-Charge regarding the true intent and meaning of the drawings and specifications shall be final and binding.
- 7.3 Any error in description, quantity or price in Schedule of Quantities and Prices or any omission therefrom shall not vitiate the Contract or release the Contractor from the execution of the whole

or any part of the Works comprised therein according to drawings and specifications or from any of his obligations under the contract.

- 7.4 If on check there is difference in the amount worked out by contractor in the schedule of quantities and prices and General summary the same shall be adjusted in accordance with the following rules:
- (a) In the event of error occurring in the amount column of schedule of quantities and prices as result of wrong multiplication of unit price and quantity, the unit price shall be regarded, as firm and multiplication shall be amended on the basis of the quoted unit price.
  - (b) All errors in totaling in the amount column and in carrying forward totals shall be corrected.
  - (c) The totals of various sections of schedule of quantities and price amended shall be carried over to the General Summary and the tendered sum amended accordingly. The tendered sum so altered shall, for the purpose of tender, be substituted for the sum originally tendered and considered for acceptance instead of the original sum quoted by the tenderer. Any rounding off of quantities or in sections of schedule of quantities and prices or in General summary by the tenderer shall be ignored.

#### **CLAUSE-8: DUTIES AND POWERS OF THE ENGINEER-IN-CHARGE REPRESENTATIVE**

- 8.1 The duties of the representative of the Engineer-in-Charge are to watch and supervise the works and to test and examine any materials/ parts to be used or workmanship employed in connection with the works.
- 8.2 The Engineer-in-Charge may, from time to time in writing, delegate to his representative any of the powers and authorities, vested in the Engineer-in- Charge and shall furnish to the contractor a copy of all such written delegation of powers and authorities. Any written instruction or written approval given by the representative of the Engineer-in-Charge to the contractor within the terms of such delegation shall bind the contractor and the Authority as though it has been given by the Engineer-in-Charge.
- 8.3 Failure of the representative of the Engineer-in-Charge to disapprove any work or materials shall be without prejudice to the power of the Engineer-in-Charge thereafter to disapprove such work or materials and to order the pulling down, removal or breaking up thereof. The contractor shall, at his own expense, again carry out such works as directed by the Engineer-in-Charge.
- 8.4 If the Contractor is dissatisfied with any decision of the representative of the Engineer-in-Charge, he will be entitled to refer the matter to the Engineer-in- Charge who shall thereupon confirm, reverse or vary such decision and the decision of the Engineer-in- Charge in this regard shall be final and binding on the contractor.

#### **CLAUSE – 9: ASSIGNMENT AND SUB-LETTING**

The Contractor shall not sub-let, transfer or assign the whole or any part of the work under the contract. Provided that the Engineer-in-Charge may at his discretion, approve and authorize the Contractor to sub-let any part of the work, which in his opinion, is not substantial, after the

contractor submits to him in writing the details of the part of the work(s) or trade proposed to be subject, to name of the sub-contractor thereof together with his past experience in the said work/trade and the form of the proposed sub-contract. Nevertheless any such approval or authorization by the Engineer-in-Charge shall not relieve the contractor from his any or all liabilities, obligations, duties and responsibilities under the contract. The contractor shall also be fully responsible to the Authority for all the acts and omissions of the sub-contractor, his employees and agents or persons directly employed by the contractor. However, the employment of piece rate works shall not be construed as sub-letting.

#### **CLAUSE – 10: FACILITIES TO OTHER CONTRACTORS**

The contractors shall, in accordance with the requirements of the work as decided by the Engineer-in- Charge, afford all reasonable facilities to other contractors engaged contemporaneously on separate contracts and for departmental labour and labour of any other agency properly authorised by Authority or any statutory body which may be employed at the site for execution of any work not included in the contract which the Authority may enter into in connection with or ancillary to the works. In all matters of conflict of interest, the Engineer-in-Charge shall direct what compromise should be made and his decision shall be final and binding on the parties.

#### **Clause – 11 : CHANGE IN CONSTITUTION**

Where the contractor is a partnership firm, prior approval in writing of the Engineer-in-Charge shall be obtained before any change is made in the constitution of the firms, where the contractor is an individual or a Hindu Undivided Family business concern, such approval, as aforesaid, shall like-wise be obtained before the contractor enters into any partnership firm which would have the right to carryout the work undertaken by contractor. If prior approval as aforesaid is not obtained the contractor shall be deemed to have been assigned in contravention to Clause 32 hereof and the same action will be taken and the same consequences shall ensure as provided for in the said clause-33.

#### **CLAUSE – 12 : COMMENCEMENT OF WORK**

The contractor shall commence the work at the respective sites within 10 days of the issue of Letter of Award. If the contractor commits default in mobilization of resources, and equipment as aforesaid, the Engineer-in-Charge shall without prejudice to any other right or remedy be at liberty to cancel the contract and forfeit the earnest money/security deposit.

#### **CLAUSE – 13 : WORKS TO BE CARRIED OUT IN ACCORDANCE WITH SPECIFICATION DRAWINGS AND ORDERS ETC.**

- 13.1 The contractor shall execute the whole and every part of the work in the most substantial and workman like manner and both as regards material and otherwise in every respect in strict conformity with the specification laid down or as may be laid down by the Engineer-in-Charge under the terms of the contract. The contractor shall also conform exactly, fully and faithfully to the designs, drawings specifications and instructions in writing in respect of the work, duly signed by the Engineer-in-Charge as may be issued from time to time.

13.2 The contractor shall be entitled to receive, on demand, in addition to the contract documents, in accordance with the provisions of contract, the documents set forth herein in respect of the work on commencement or during the performance of the contract:

- (a) Contract drawings and revisions thereof
- (b) Specifications or revisions thereof other than standard printed specifications
- (c) Explanations, instructions etc.

Such further drawings, explanation, modifications and instruction, as the Engineer-in-Charge may issue to the contractor from time to time in respect of the work shall be deemed to form integral part of the contract and the contractor shall be bound to carry out the work accordingly.

13.3 All instructions and orders in respect of the work shall be given by the Engineer-in-Charge in writing. However, any verbal instructions or order shall be confirmed by the Engineer-in-Charge as soon as practicable without loss of time and only such written instruction shall be deemed to be valid.

#### **CLAUSE – 14 : SETTING OUT THE WORKS**

14.1 The Engineer-in-Charge or his representative shall establish/indicate the location layout of specified works of the above terminal.

14.2 The contractor shall be responsible for the true and proper setting out of all the work (in relation to the aforementioned alignment) for the correctness of the location, grades, dimensions and alignment of all components of the work and for the provision of all instruments, appliances, materials and labour required in connection therewith. If any time during the progress of the work any error shall appear or arise in the location, grades, dimensions, or alignment or any part of the work the contractor on being required to do so by the Engineer-in-Charge, shall at his own expense, rectify such error to the satisfaction of the Engineer-in-Charge.

14.3 The contractor shall afford all reasonable facilities and assistance to the Engineer-in-Charge for checking the setting out and lines and grades established by the contractor. The checking of any setting out or of any line and grade by the Engineer-in-charge shall not in any way relieve the contractor of his responsibility for the correctness thereof.

#### **CLAUSE – 15 : URGENT WORKS**

If any urgent work (in respect where the decision of the Engineer-in-Charge shall be final and binding) becomes necessary, the contractor shall execute the same as may be directed, provided the directions are in accordance and confirmatory with provisions in Clause – 8.

#### **CLAUSE – 16 : DEVIATIONS**

16.1 The Engineer-in-Charge shall have powers to make any deviations in the original specifications of the works or any part thereof that are in his opinion, necessary at the time of or during the course of execution of the works for the aforesaid purpose or for any other reason, if it shall, in the opinion of the Engineer-in-Charge, be desirable, he shall also have the powers to make Deviations, such as (i) Variations (ii) Extra (iii) Additions / Omissions and (iv) Alterations or

Substitutions of any kind. No such Deviations in the specification or drawings or designs or Schedule of Quantities, as aforesaid, shall in any way vitiate or invalidate the contract and any such Deviations which the contractor may be directed to do shall form integral part of the contract as if originally provided therein and the contractor shall carry out the same on the same conditions in all respects on which he agreed to do the works under the contract.

- 16.2 Such items of work, as are required, to be executed at the rates already provided in the schedule of quantities, shall apply in respect of the same item(s) of work to be executed due to Variation.
- 16.3 If requested by the contractor the time for completion of the work shall, in the event of any deviation resulting in additional cost over the contract sum be extended in the proportion which altered, additional or substituted work bears to the original contract sum plus such further additional time as may be considered reasonable by the Engineer-in-Charge whose decision shall be conclusive as to such provision:
- 16.4 Under the circumstances, the contractor shall at any stage not suspend the work on account of non-settlement of rates of such Deviated items.

#### **CLAUSE - 17: CONTRACTORS SUPERVISION**

- 17.1 The contractor shall either himself supervise the execution of the works or shall appoint at his own expense, an Engineer as his accredited agent approved by the Engineer-in-Charge, if contractor has himself not sufficient knowledge or experience to be capable of receiving instruction or cannot give his full attention to the works. The contractor or his agent shall be present at the site(s) and shall superintend the execution of the works with such additional assistance in each trade, as the work involved shall require and considered reasonable by the Engineer-in-Charge, directions/instructions given by the Engineer-in-Charge to the contractor's agent shall be considered to have the same force as if these had been given to the contractor himself.
- 17.2 If the contractor fails to appoint a suitable agent as directed by the Engineer-in-Charge, the Engineer-in-Charge shall have full powers to suspend the execution of the works until such date as a suitable agent is appointed by the contractor and takes over the supervision of the work. For any such suspension, the contractor shall be held responsible for delay so caused to the works.

#### **CLAUSE - 18 : INSTRUCTION AND NOTICE**

- 18.1 Except as otherwise provided in this contract, all notices to be given on behalf of the Authority and all other actions to be taken on its behalf may be given or taken by the Engineer-in-Charge or any officer for the time being entrusted with the functions duties and powers of the Engineer-in-Charge.
- 18.2 All instructions, notices and communications etc. under the contract shall be given in writing and any such oral orders / instructions given shall be confirmed in writing and no such communication which is not given or confirmed in writing shall be valid.

- 18.3 All instructions, notices and communications shall be deemed to have been duly given or sent to the contractor, if delivered to the contractor, his authorized agent, or left at, or posted to, the address given by the contractor or his authorized agent or to the last known place of abode or business of the contractor or his agent of services by post shall be deemed to have been served on the date when in the ordinary course of post these would have been delivered to him and in other cases on the day on which the same were so delivered or left.
- 18.4 The Engineer-in-Charge shall communicate or confirm the instructions to the contractor in respect of the execution of work in a work site order book maintained in the office of the Engineer-in-Charge and the contractor or his authorized representative shall confirm receipt of such instructions by signing the relevant entries in this book. If required by the Contractor, he shall be furnished a certified true copy of such instruction(s).

#### **CLAUSE -19: PLANT AND EQUIPMENT**

- 19.1 The Contractors shall provide and install all necessary plant; equipment and machinery required for the execution of the work under the contract, at his cost and shall use such methods and appliances for the purpose of all the operations connected with the work covered by the contract, which shall ensure the completion of work(s) within the specified time.
- 19.2 Subject to the availability of any item(s), plant, equipment and machinery the Authority at the written request of the contractor, may issue to the contractor on hire for being deployed on the work contracted for, at pre- determined rates, terms and conditions at the sole discretion of the Engineer-in-Charge.

#### **CLAUSE – 20 : PATENT RIGHTS**

- 20.1 The contractor shall indemnify the Authority, its representatives or its employees against any action, claim or proceeding relating to infringement or use of any patent or design or any alleged patent or design rights and shall pay any royalties or other charges which may be payable in respect of any article or material or part thereof included in the contract. In the event of any claim being made or action being brought against the Authority or any agent, servant or employee of the Authority in respect of any such materials as aforesaid the contractor shall immediately be notified thereof. Provided that such indemnity shall not apply when such infringement has taken place in complying with the specific directions issued by the Authority but the contractor shall pay any royalties or other charges payable in respect of any such use, the amount so paid being reimbursement to the contractor only if the use was the result of any drawings and or specifications issued after submission of the tender.
- 20.2 The contractor shall at his own cost and expense, defend all suits or proceedings that may be instituted for alleged infringement of any patents involved in the works and in case of an award of damages, the contractor shall pay for such award. In the event of any suit or proceedings instituted against the owner, the same shall be defended at the cost and expense of the contractor who shall also satisfy/ comply any decree, order or award made against the owner.
- 20.3 Neither the contractor nor through any counsel engaged by the contractor shall defend himself in the name of the Authority in any suit or proceedings.

20.4 The Authority shall not be under any obligation to make the final payments to the contractor till any such suit or claim remains unsettled.

#### **CLAUSE – 21 : MATERIALS**

21.1 The contractor shall at his own expenses provide / arrange all materials required for the bonafide use on work under the contract.

21.2 All materials parts to be provided by the contractor shall be in conformity with the specifications laid down in the contract and the contractor shall furnish from time to time proof and samples, at his cost, of the materials parts as may be specified by the Engineer-in-Charge shall also have powers to have such tests, in addition to those specified in the contract, as may be required and the contractor shall provide all facilities to carry out the same. The cost of materials parts consumed in such tests and also expenses incurred thereon shall be borne by the contractor in all cases and also where such tests which are in addition to those provided in the contract disclose that the materials are in conformity with the provisions of the contract.

21.3 The Engineer-in-Charge or his representative shall be entitled at any time to inspect and examine any materials parts intended to be used in or the works, either on the site or at factory or workshop or other place(s) where such materials are assembled, fabricated, manufactured or any place where these are lying or from where these are being obtained. For this, purpose, the contractor shall afford such facilities as may be required for such inspection and examination.

#### **CLAUSE - 22: LAWS GOVERNING THE CONTRACT**

The Courts at Guwahati only shall have the jurisdiction for filing the award of the arbitration and for any other judicial proceedings.

#### **CLAUSE - 23: WATCHING AND LIGHTING**

The Contractor shall provide and maintain at his expense all lights, guards, fencing and watching when and where necessary or as required by the Engineer-in- Charge for the protection of the works or for the safety and convenience of those employed on the works or the public.

#### **CLAUSE - 24: WORK DURING NIGHT OR ON SUNDAYS AND HOLIDAYS**

24.1 Subject to any provisions to the contrary contained in the contract, none of the works shall be carried out during national holidays without the permission in writing of the Engineer-in-Charge. However, when work is unavoidable or necessary for safety of life, property or works, contractor shall take necessary action immediately and advise the Engineer-in-Charge accordingly.

24.2 The Engineer-in-Charge at its discretion may, however, direct the contractor that the work may be carried out on holidays, Sundays and/ or extra shifts to ensure completion of works under the contract as scheduled.

## **CLAUSE - 25 : LABOUR**

- 25.1 (a) The contractor shall employ labour in sufficient numbers to maintain the required rate of progress and of quality to ensure workmanship of the degree specified in the contract and to the satisfaction of the Engineer-in-Charge. The Contractor shall not employ in connection with the works any person who has not completed eighteen years of age the minimum age specified in Indian Labour Law.
- (b) If any foreigner is employed by the contractor to work within the site the later shall ensure that such foreigner possesses the necessary special permit issued by the civil Authorities in writing and also comply with the instructions issued therefore from time to time. In the event of any lapse in this regard on the part of such foreigner the contractor shall be personally held responsible for the lapse & Authority shall not be liable in any event.
- (c) The Contract is liable for cancellation if either the contractor himself or any of his employee is found to be a person who has held class-I post under the Authority immediately before retirement and has within two years of such retirement accepted without obtaining the previous permission of the Authority or of the Chairman as the case may be and employment as contractor for, or in connection with the execution of the public works, or as an employee of such contractor. If the contract is terminated on account of the failure of the contractor to comply with the above clause, The Authority shall be entitled to recover from him such damages as may be determined by the Engineer-in-Charge with due regard to the inconvenience caused to the Authority on account of such termination without prejudice to the Authority's right to proceed against such officer.
- 25.2 The contractor shall furnish and deliver fortnightly to the Engineer-in-Charge, a distribution return of the number and description by trades of the works of people employed on the works. The contractor shall also submit on the 4th and 19th of every month for the period of second half of the preceding month and first half of the current month respectively to the Engineer-in-Charge, a true statement in respect of the following.
- i) Any accidents if occurred during the said fortnight showing the circumstances under which they happened and the extent of damage and injury caused by them and.
- ii) the number of female workers who have been allowed maternity benefit as provided in the Maternity Benefit Act 1961 or Rules made thereunder and the amount paid to them.
- 25.3 The Contractor shall pay to labourer employed by him either directly or through sub-contractors wages not less than wages as defined in Minimum Wages Act and amendments made from time to time.
- 25.4 The Contractor shall in respect of labour employed by him either directly or though sub-contractor comply with or cause to be complied with the contract labour (Regulation and Abolition) Act 1970 and Rules framed there under in regard to all matters provided therein.
- 25.5 The Contractor shall comply with the provision of all the Acts Laws, any Regulation or Bye Laws of any Local or other Statutory Authority applicable in relation to the execution of works such as :

- i) Payment of wages Act.1936 (Amended)
- ii) Minimum wages Act. 1948 (Amended).
- iii) The Contract Labour (Regulation & Abolition) Act, 1970 with Rules framed there under as amended.
- iv) Workmen Compensation Act. 1923 as amended by Amendment Act No. 65 of 1976.
- v) Employer's Liability Act 1938 (Amended)
- vi) Maternity Benefit Act. 1961 (Amended)
- vii) The Industrial Employment (Standing orders) Act 1946 (Amended).
- viii) The Industrial Disputes Act. 1947 (Amended)
- ix) Payment of bonus Act.1965 and Amended Act No. 43 of 1977 and No. 48 of 1978 and any amended thereof:
- x) The Personal Injuries (Compensation Insurance) Act 1963 and any modifications thereof and rules made there under from time to time. The Contractor shall take into account all the above and financial liabilities in his quoted rates and nothing extra, whatsoever, shall be payable to him on this account.

25.6 The Contractor shall be liable to pay his contribution and the employees contribution to the State Insurance Scheme in respect of all labour employed by him for the execution of the contract, in accordance with the provision of "the Employees State insurance Act 1948" as amended from time to time. The contractor agrees to indemnify and hold the owner harmless from any liability or penalty which may be imposed by any central or state Authority and also of any claims, suits or proceedings that may be brought against the Authority arising under, growing out of or by reasons of work proved by this contract whether brought by employees of the Contractor, by third parties or by Central or State Authority or any political sub division thereof. In case the Contractor fails to submit full details of his account of labour employed and the contribution payable the Engineer-in- Charge shall recover from the running bills of the contribution an amount of contribution as assessed by him. The amount so recovered shall be adjusted against the actual contribution payable for Employees State Insurance.

25.7 The Engineer-in-Charge shall on a report having been made by an inspecting officer as defined in the Contract Labour (Regulation and Abolition) Act and Rules or on his own in his capacity as Principal Employer, have the power to deduct from the amount due to the contractor any sum required on estimated to be required for making good the loss suffered by worker(s) by reason of non-fulfillment of the conditions of the Contract for the benefit of Workers, nonpayment of wages or of deduction made from him for wages which are not justified by the terms of the contract or non- observance of the said Act and Rules framed there under with amendments made from time to time.

25.8 The Contractor shall indemnify the Authority against any payments to be made under and for observance of the Regulation Laws, Rules as stipulated in Clause-25.5 above without prejudice to his right to claim indemnity from his sub-contractors. In the event of the contractor's failure to comply with the provisions of all the Act/Laws stipulated in Clause-25.5 or in the event of decree or award or order against the contractor having been received from the competent authority on account of any default or breach or in connection with any of the provisions of the Act/Law/Rules mentioned in Sub-Clause 25.5 above , the Engineer-in-Charge without prejudice to any other right or remedy under the contract shall be empowered to deduct such sum or sums from the Bill of the contractor or from his security deposit or from other payment due under this contract or any other contract to satisfy within a reasonable time the

provisions of the various Act/Laws/Rules/Codes as mentioned under Sub-Clause 25.5 above, on the part of the contractor under the contract on behalf of and at the expenses of the contractor and make payment and /or provide amenities/facilities/services accordingly. In this regard, the decision of the Engineer-in-Charge shall be conclusive and binding on the contractor.

- 25.9 In the event or the Contractor committing a default or breach of any of the provisions of the aforesaid Contract's Labour (Regulation and Abolition) Act and Rules as amended from time to time or furnishing any information or submitting or filling any form/Register/Slip under the provisions of these Regulations which is materially incorrect then on the report of the Inspecting officer as defined in the relevant Acts and Rules as referred in Clause 25.5 above, the Contractor shall without prejudice to any other liability pay to the Authority a sum not exceeding Rs.50/- (Rs. fifty only) as liquidated damages for every default, breach or furnishing, making, submitting, filling materially incorrect statement as may be fixed by the Engineer-in-Charge. The decision of the Engineer-in-Charge in this respect shall be final & binding.
- 25.10 The Contractor shall at his own expenses Comply with or cause to be complied with the Provisions/ Rules provided for welfare and health of Contract Labour in the Contract Labour (Regulation and Abolition) Act and other relevant Acts and Rules framed there under or any other instructions issued by the Authority in this regard for the protection of health and for making sanitary arrangements for workers employed directly or indirectly on the works. In case, the contractor fails to make arrangements as aforesaid, the Engineer-in-Charge shall be entitled to do so and recover the cost thereof from the contractor.
- 25.11 The Contractor shall at his own expense arrange for the safety or as required by the Engineer-in-Charge, in respect of all labour directly or indirectly employed for performance of the Works and shall provide all facilities in connection therewith. In case the contractor fails to make arrangements and provide necessary facilities as aforesaid, the Engineer-in-Charge shall be entitled to do so and recover the cost thereof from the Contractor. But this will not absolve the contractor of his responsibility or otherwise thereof.
- 25.12 Failure to comply with "Provisions/Rules made for Welfare and Health of Contract Labour" Safety Manual, or the provisions relating to report on accidents and grant of maternity benefits to female workers and the relevant Act/Rules referred in clause 25.5 above shall make the contractor liable to pay to the Authority as liquidated damages an amount not exceeding Rs. 50/- for each default or materially incorrect statement. The decision of the Engineer-in-Charge in such matters based on reports from the inspecting Officers as defined in the relevant Acts and Rules as referred in clause 25.5 above shall be final and binding and deductions for recovery of such liquidated damages may be made from any amount payable to the contractor. In the event of any injury, disability or death of any workmen in or about the work employed by the contractor either directly or through his sub-contractor, contractor shall at all time indemnify and save harmless the Authority against all claims, damages and compensation under the Workmen Compensation Act. 1923 as amended from time to time or in other Law for the time being in force and Rules there-under from time to time and also against all costs, charges and expenses of any smooth action by proceedings arising out of such accidents or injury, disability or death of a workmen and against all sum or sums which may with the consent of the contractor be paid to compromise or compound any claim in this

regard. If any award, decree or order is passed against the contractor for recovery of any compensation under the Workmen Compensation Act, 1923, for any injury, disability or death of a workman by any competent court, the said sum or sums shall be deducted by the Engineer-in-Charge from any sum then due or that may become due to the contractor or from his security deposit or sale thereof in full or part under the contract or any other contract with the Authority towards fulfillment of the said decree, award or orders.

25.13 Provided always that the contractor shall have no right to claim payments/claims whatsoever on account of his compliance with his obligations under this clause and Labour Regulation.

25.14 Alcoholic liquor or drugs:

The contractor shall not otherwise than in accordance with the statutes ordinance and Government Regulations or orders for the time being in force import, sell, give, barter or otherwise dispose of any alcoholic liquor or drugs to permit or suffer any such import, sale, gift, barter or disposal by his sub-contractor, agent or employees.

25.15 Arms and Ammunition:

The contractor shall not give, barter or otherwise dispose of to any person or persons any arms or ammunition of any kind or permit to suffer the same as aforesaid.

25.16 Removal of Contractor's men :

The Contractor shall employ for the execution of the works only such persons as are skilled and experienced in their respective trades and Engineer-in-Charge shall be at liberty to object to and require the contractor to remove from the works any persons employed by the Contractor for the execution of the works who, in the opinion of the Engineer-in-Charge, misconduct himself or is incompetent or negligent in the proper performance of his duties. The contractor shall forthwith comply with such requisition and such person shall not be again employed upon the works without written permission of the Engineer-in-Charge. Any person so removed from the work shall be immediately replaced at the expense of the contractor by a qualified and competent substitute. Should the contractor be requested to repatriate any person removed from the work, he shall do so and shall bear all costs in connection herewith.

**CLAUSE – 26 : MATERIALS OBTAINED FROM EXCAVATION AND TREASURE TROVE, FOSSILS, ETC.**

26.1 Materials of any kind obtained from excavation on the site shall remain the property of the Authority and shall be disposed off as directed by the Engineer-in-Charge.

26.2 However if any of the materials thus obtained from excavation on the site is such as can be used in the execution of the work under the contract, the contractor will be allowed to use the same free of cost (except that any amount of royalty paid for in this regard by the Authority shall be recoverable from the contractor) for the aforesaid purpose provided the same is found suitable and is approved by the Engineer-in-Charge.

26.3 Fossils, coins, articles of value, structures and other remains or things of geological or Archeological interest discovered on the site shall be the absolute property of the Authority. The contractor shall take reasonable precautions to prevent his labour or any other person from removing or damaging any such article or thing and shall acquaint the Engineer-in-Charge with

such discovery and carryout the Engineer-in-Charge's directions as to the disposal of the same at the expense of the Authority.

#### **CLAUSE – 27: FORCE MAJEURE**

- 27.1 The term Force Majeure shall herein mean Riots (other than among the contractor's employees), Civil Commotion (to the extent no insurable), war (whether declared or not), invasion, act of foreign enemies, hostilation, civil war, rebellion, revolution, insurrection, military or usurped power, damage from aircraft, nuclear fission, acts of God, such as earthquake (above 7 magnitude on Richter Scale), lightning, unprecedented floods, fires not caused by contractor's negligence and other such causes over which the contractor has no control and are accepted as such by the Engineer-in-Charge, whose decision shall be final and binding. In the event of either party being rendered unable by Force Majeure to perform any obligation required to be performed by them under this contract, the relative obligation of the party affected by such Force Majeure shall be treated as suspended for the period during which such Force Majeure cause lasts, provided the party allowing that it has been rendered unable as aforesaid, thereby shall notify within 15 days of the alleged beginning and ending thereof giving full particulars and satisfactory evidence in support of such cause.
- 27.2 For delays arising out of Force Majeure, the bidder shall not claim extension in completion date for a period exceeding the period of delay attributable to the causes of Force Majeure and neither the Authority nor the bidder shall be liable to pay extra costs provided it is mutually established that Force Majeure conditions did actually exist.
- 27.3 If any of the Force Majeure conditions exists in the places of operation of the bidder even at the time of submission bid, he shall categorically specify in his bid and state whether they have been taken into consideration in their quotations.

#### **CLAUSE - 28 : LIABILITY FOR DAMAGE, DEFECTS OR IMPERFECTIONS AND RECTIFICATION THEREOF**

- 28.1 If the contractor or his labour or sub-contractor, injure destroy or damage, Battery, Solar panel, lighting system, road, fence, enclosures, water pipe, cables, buildings, drains, electricity or telephone posts, wires, trees, grass line, cultivated land in the area in which they may be working or in the area contiguous to the premises on which the work or any part of it is being executed or if any damage is caused during the progress of work, the Contractor shall upto receipt of a notice in writing in that behalf from the Engineer-in-Charge, make the same good at his cost.
- 28.2 If it appears to the Engineer-in-Charge or his representative at any time during to or prior to the expiration of the Defects Liability period that any work has been executed with unsound, imperfect or unskilled workmanship or that any materials or articles provided by the Contractor for execution of the work are unsound or of a quality inferior to that contracted for, or otherwise not in accordance with the Contract, or that any defect, shrinkage or other faults found in the work arising out of defective or improper materials or workmanship, the Contractor shall, upon receipt of a notice in writing in that behalf from the Engineer-in-Charge forthwith rectify or remove and reconstruct the work so specified in whole or in part, as the

case may be, and/or remove the materials/articles so specified and provide other proper and suitable materials at his expense.

- 28.3 All damages caused by accidents or carelessness of the contractor or any of his employees or any property belonging to the Authority is wasted or is misused by the contractor or any of his employee shall be to the account of the contractor, who shall make good the loss.

#### **CLAUSE – 29 : CONTRACTOR'S LIABILITY AND INSURANCE**

- 29.1 From commencement to completion of the work(s) as a whole, the Contractor shall take full responsibility for the care thereof and for taking precautions to prevent loss or damage. He shall be liable for any damage or loss that may happen to the works or any part thereof and to the Authority's Plant, Equipment and Material (hired or issued to the Contractor) shall be in good order and condition and in conformity in every respect with the requirements of the Contract and instructions of the Engineer-in-Charge.
- 29.2 i) Neither party to the contract shall be liable to the other in respect of any loss or damage which may occur or arise out of "Force Majeure" to the works or any part thereof on to any material or article at site but not incorporated in the works or to any person or anything or material whatsoever or either party provided such a loss or damage could not have been foreseen or avoided by a prudent person and the either party shall bear losses and damages in respect of their respective men and materials. As such liability of either party shall include claims/ compensations of the third party also.
- ii) Provided, however, in an eventuality as mentioned in sub-clause - 29.2 (i) above, the following provisions shall also have effect :
- (a) The Contractor shall, as may be directed in writing by the Engineer-in-Charge proceed with the completion of the works under and in accordance with the provisions and conditions of the contract, and
  - (b) The Contractor shall, as may be directed in writing by the Engineer-in-charge, re-execute the works lost or damaged, remove from the site any debris and so much of the works as shall have been damaged and carry the Authority's T & P, Plant and Equipment, Material etc. to the Authority's store. The cost of such re-execution of the works, removal of damaged works and carrying of Authority's store shall be ascertained in the same manner as for deviations and this shall be added to the contract sum. Provided always that the Contractor shall, at his own cost, repair and make good so much of the loss or damage as has been occasioned by any failure on his part to perform his obligations under the contract or not taking precautions to prevent loss or damage or minimize the amount of such loss or damage, Final assessment of loss or damage shall be decided by the Engineer-in-Charge and his decision shall be final and binding.
- 29.3 The contractor shall take special precautions to see that public places and roads adjacent to contractor's yard are not blocked at anytime either by his material or by his workmen. The roads are to be kept always clear and no equipment/materials shall be stacked.

- 29.4 The navigable waterways shall not be blocked by Contractor. The anchors dropped in the waterways shall be properly marked and removed after done with.
- 29.5 The contractor shall indemnify and keep indemnified the Authority against all losses and claims for death, injuries or damage to any person or any property whatsoever which may arise out of or in consequence of the construction and maintenance, of works during the contract period and also against all claims, demands, proceedings, damages, costs, charges and expenses whatsoever in respect of or in relation thereto, and such liabilities shall include claims/compensations of the third party.
- 29.6 (a) Before commencing execution of the work, the Contractor shall without in any way limiting his obligations and responsibilities under this condition, insure against any damage, loss or injury which may occur to any property (excluding that of the Authority but including the Authority building rented to the contractor wholly or in part and any part of which is used in part and any part of which is used by him for storing combustible materials) public liability by arising out of the carrying out of the contract. For this purpose the contractor shall take out, pay all costs and maintain throughout the period of his contract public liability with the following coverage.
- i) Public liability limits for bodily injury or death not less than Rs. 1,00,000 for one person and Rs. 2,00,000 for each accident.
  - ii) Property liability limits for each accident not less than Rs. 1,00,000 ;
  - iii) The Contractor shall prove to the Engineer-in Charge from time to time that he has taken out all the insurance policies referred to above and has paid the necessary premiums for keeping the policies alive till expiry of the Defects Liability Period.
- (b) The Contractor shall ensure that similar insurance policies are taken out by his sub-contractor (if any) and shall be responsible for any claims or losses to the Authority resulting from their failure to obtain adequate insurance protection in connection thereof. The Contractor shall produce or cause to be produced by his sub-contractors (if any) as the case may be, relevant, policy or policies and premium receipt as and when required by the Engineer-in-Charge.
- (c) If the contractor and/or his sub- contractor (if any) shall fail to effect and keep in force the insurance referred to above or any other insurance which he/they may be required to effect under the term of the Contract then and in any such case the Authority may, without being bound to effect and keep in force any such insurance and pay such premium or premiums as may be necessary for that purpose and from time to time deduct the amount so paid by the Authority from any moneys due or which may become due to the contractor or recover the same as a debt due from the contractor.
- (d) The contractor shall at his own expense arrange for the safety provisions as required in respect of the works covered under this contract as per the instruction of Engineer-in-charge. In case, the contractor fails to comply with the provisions of the safety the Engineer- in-Charge shall be entitled to and make the necessary arrangements at the risk and cost of the contractor. This will, however, not absolve the Contractor of his overall responsibility to execute the works under the contract.

**CLAUSE – 30 : SUSPENSION OF WORKS**

30.1 The contractor shall on the order of the Engineer-in-Charge suspend the progress of the works or any part thereof for such time or times and in such manner as the Engineer-in-Charge may consider necessary and shall during such suspension properly protect and secure the work so far as is necessary in the opinion of the Engineer-in-Charge.

**CLAUSE – 31: FORECLOSURE OF CONTRACT IN FULL OR IN PART DUE TO ABANDONMENT OR REDUCTION IN SCOPE OF WORK**

If at any time after acceptance of the tender the Authority decides to abandon or reduce the scope of the works for reason whatsoever and hence does not require the whole or any part of the works to be carried out, the Engineer-in-Charge shall give notice in writing to that effect to the contractor and the Contractor shall have no claim to any payment of compensation or otherwise whatsoever, on account of any profit or advantage which he might have derived from the execution of the works in full but which he could not derive in consequence of the fore closure of the whole or part of the works.

**CLAUSE – 32 : TERMINATION OF CONTRACT ON DEATH**

If the Contractor is an individual or a proprietary concern and the individual or the proprietor dies, or if the Contractor is a partnership concern and one of the partners dies, then, unless the Engineer-in-Charge is satisfied that the legal representatives of the individual contractor or of the proprietor of the proprietary concern and in the case of partnership, the surviving partners are capable of carrying out and completing the contract, the Engineer-in-Charge shall be entitled to terminate the Contract as to its incomplete part without the Authority being in anyway liable to payment of any compensation whatsoever on any account to the estate of the deceased Contractor and/or to the surviving partners of the Contractor's firm on account of termination of the Contract. The decision of the Engineer-in-Charge that the legal representatives of the deceased contractor or the surviving partners of the Contractor's firm cannot carry out and complete the works under the contract shall be final and binding on the parties. In the event of such termination, the Authority shall not hold the estate of the deceased Contractor and/or the surviving partners of the Contractor's firm liable for damages for not completing the contract. Provided that the power of the Engineer-in-Charge of such termination of contract shall be without prejudice to any other right or remedy which shall have accrued or shall accrue to him under the contract.

**CLAUSE– 33 : CORRUPT PRACTICE & TERMINATION OF CONTRACT IN FULL OR IN PART**

33.1 If the Contractor does not commence the work in the manner described in the Contract document or if he shall at any time in the opinion of the engineer.

- (i) Commits default in complying with or commits breach of any of the terms and conditions of the contract and does not remedy it or take effective steps to remedy it immediately and not later than 15 days in any case after a notice in writing is given to him in that behalf by the Engineer-in-Charge; or

- (ii) Fails to complete the work (s) or any item of work (s) within the time or any extended time under the contract and does not complete the work (s) or any item of works within the period specified in a notice given in writing in that behalf by the Engineer-in-Charge ; or
- (iii) Fails to carry on the work in conformity/ accordance with the contract document or mobilize/ supply suitable equipments, labour, materials or other equipments to the site as stipulated in the contract, or
- (iv) Fails to commence, carry and execute the work to the satisfaction of the EIC, or
- (v) Abandon the work, or
- (vi) Substantially suspend the work or the works for a minimum period of 30 days without any authority/ prior permission of EIC, or
- (vii) Commit or suffer or permit any other breach of any of the provisions and terms of the Contract to be performed by him or it is observed that the said breach persists 15 days, after notifying to the Contractor in writing by the engineer requiring such breach to be remedied or
- (viii) The contractor becomes bankrupt, insolvent or goes into liquidation whether compulsory or voluntary not being merely a voluntary liquidation for the purpose of amalgamation or reconstruction which amalgamations or reconstruction would assume complete responsibility and liability of the work with the prior approval of the owner and would furnish all guarantees by new formation.
- (ix) Assigns, transfers, sublets (engagement of labour on a piece-work basis or of labour with materials not being incorporated in the work shall not be deemed to be subletting) or attempts to assign, transfer or sublet the entire works or any portion thereof without the prior written approval of the Engineer-in-Charge. The Engineer-in-Charge shall have powers to terminate the contract in full or in part as aforesaid without prejudice to any other right or remedy which shall have accrued or shall accrue of which cancellation notice in writing to the Contractor under the hand of the Engineer-in-Charge shall be conclusive evidence.

Then the Authority shall have the power to enter upon the work and take possession of all the equipments of the contractor thereon, and to remove the contractor's license to the same and to complete the work by his agents or other contractor or workmen or to relate the same upon any terms and conditions and so such other person, firm or corporation as the owner in his absolute discretion may think proper to employ and for the purpose of completion of the work specified in the contract, and without any payment/allowance to the contractor for the use or of the equipment or being liable for any loss or damage thereto the equipments. If the Authority shall by reason of its taking the possession of the works being completed by other contractors (due account being taken of such extra work or works which may be omitted) then the amount of such excess work or works which may be due for work done by the contractor under the contract and not paid for.

In case of any deficiency to be paid to the Authority by the contractor, the contractor shall make or in case of any deficiency remaining unsettled then the Authority shall have the power to sell in such a manner and for such a price as it may think fit all or any of the equipments belonging to the contractor and to recoup and retain the said deficiency or any part thereof out of the sale proceeds.

- 33.2 **Corrupt Practice :** The Contractor shall not offer or to give to any person in the employment of the Authority or working under the orders of the Chairman any gift or consideration of any kind as an inducement or reward for doing or forbearing to do or for having done or forborne to do any act in relation to the obtaining or execution of the contract or any other contract with the purchaser or for showing or forbearing to show favour or disfavour to any person in relation to the contract or any other contract with the purchaser. Any breach of the aforesaid condition by the contract, or any one employed, by him or acting on his behalf (whether with or without the knowledge of the Contractor) or the commission of any offence by the Contractor or by any one employed by him or acting on his behalf under Chapter IX of the Indian Penal code 1860 or the Prevention of Corruption Act. 1947 or any other Act enacted for the prevention of corruption by Public Servant shall entitle the Chairman to cancel the contract and all or any other contracts with the Contractor and to recover from the Contractor the amount of any loss arising from such cancellation in accordance with the provisions of General condition and Special conditions.
- 33.3 The Engineer-in-Charge shall, on such termination of the contract, have powers
- i) To take possession of the site of work under the contract as well as the land / premises allotted to the contractor for his preliminary, Enabling and Ancillary works and
  - ii) Also any materials, constructional plant, equipment, implements, stores, structures etc. thereon. The Engineer-in-Charge shall also have powers to carry out the incomplete work by any means or through any other agency or by himself at the risk and cost of the contractor. In such agencies shall be credited to the contractor at his contract prices and the contractor shall pay the excess amount, if any, incurred in completing the work as aforesaid, as stipulated under sub-clause 30.5 hereunder.
- 33.4 On termination of the contract in full or part, the Engineer-in-Charge may direct that a part or whole of such plant, equipment and materials, structures be removed from the site of the work as well as from the land/premises allotted to the contractor for his preliminary, enabling and ancillary works, within a stipulated period if the contractor shall fail to do so within the period specified in a notice in writing by the Engineer-in-Charge, the Engineer-in-Charge may cause then to be sold, holding the net proceeds of such sale to the credit of the contractor, which shall be released after completion of works and settlement of amounts under the contract.
- 33.5 If the expenses incurred or to be incurred by the Authority for carrying out and completing the incomplete work or part of the same, as certified by the Engineer-in-Charge, are in excess of the value of the work credited / to be credited to the contractor, the difference shall be paid by the contractor to the Authority. If the contractor fails to pay such an amount , as aforesaid, within thirty days of receipt of notice in writing from the Engineer-in-Charge, the Engineer-in-Charge shall be empowered to recover such amount from any sum due to the contractor on any account under this or any other contract or from his security deposit or otherwise.
- 33.6 Also, the Engineer-in-Charge shall have the right to sell any or all of the contractor's unused materials, constructional plant, equipment, implements, temporary building / structures etc. and apply the proceeds of sale thereof towards the satisfaction of any sums due from the contractor under the contract and if thereafter there may be any balance outstanding from the contractor, the Engineer-in-Charge shall have powers to recover the same in accordance with the provisions of the contract.

- 33.7 The contractor shall not construct any structure even of a temporary nature for any other purpose on IWAI office premises & Engineer-in-Charge's representative's office or houseboat, or any such things except with the written permission of the EIC and any such construction, so put up shall be removed by the contractor whenever the EIC or his representative calls upon the contractor to remove. Any dispute or difference in respect of either the interpretation effect or application of the above conditions or of the amount recoverable there under by the purchaser from the Contractor, shall be decided by the Chairman.
- 33.8 IWAI also reserves its right to determine/ terminate the contract on following basis :
- (i) Authority shall, at any time, be entitled to determine and terminate the contract, for any cause whatsoever. A notice in writing from the Owner to the Contractor shall be issued giving 15 (fifteen) days time for such determination and termination including the reason thereof.
  - (ii) The contractor upon receipt of such notice, shall discontinue the work on the date and to the extent specified in the notice, make all reasonable efforts to obtain cancellation of all orders and contracts to the extent they are related to work terminated, and upon terms satisfactory to the Authority, stop all further sub-contracting or purchasing activity, related to the work terminated and assist the Authority in maintenance, protection and disposition of the works acquired under the contract by the Authority.
  - (iii) Should the contract be determined under the sub-clause (i) of the said clause, the Contractor shall be paid compensation, equitable and reasonable dictated by the circumstances prevalent at the time of termination.”.

#### **CLAUSE - 34 : COMPLETION TIME AND EXTENSIONS**

- 34.1 Time allowed for execution of the work as specified or the extended time, if any, in accordance with these conditions shall be essence of the contract.
- 34.2 However, if the work is delayed on account of:
- i) Increase in the quantity of work to be done under the contract as per clause 16, or
  - ii) Suspension of work as per clause 30 ; or
  - iii) Rebuilding of work as per clause 31; or
  - iv) "Force Majeure" as per clause 27; or
  - v) Any other cause which, in absolute discretion of the Engineer-in- Charge is beyond the contractor's control; then immediately upon the happening of any such events as aforesaid, the contractor shall inform the Engineer-in-Charge accordingly, but the contractor shall nevertheless use constantly his best endeavors to prevent and/or make good the delay and shall do all that may be required in this regard. The Contractor shall also request, in writing, for extension of time, to which he may consider himself eligible under the contract, within fourteen days of the date of happening of any such events as indicated above.
- 34.3 In any such case as may have arisen due to any of the events, as aforesaid, and which may have been brought out by the contractor in writing, the Engineer-in-Charge may give a fair and reasonable extension of time, after taking into consideration the nature of the work delayed and

practicability of its execution during the period of extension. Provided in the event of non-receipt of a request for such extensions from the contractor for reasons whatsoever, the Engineer-in-Charge may, at his sole discretion and with due regard to the event, grant fair and reasonable extension of time not more than 1/3rd of the total completion period without any financial implication. Such extensions, if admissible, shall be communicated to the contractor by the Engineer-in-Charge in writing within one month of the date of receipt of such request or within one month of the occurrence of the event, but in any case before expiry of the contract period.

#### **CLAUSE – 35 : COMPENSATION FOR DELAY**

35.1 If the contractor fails to complete all items of works in respect of any of the sub- group/group and/or work as a whole as the case may be and before the expiry of the period(s) of completion as stipulated in the aforesaid tender or any extended period (not due to the fault of the contractor) as may be allowed, he shall without prejudice to any other right or remedy of the Authority on account of such default, pay as an ascertained/agreed compensation as per Clause No. 36.

#### **CLAUSE – 36 : LIQUIDATED DAMAGES**

36.1 If the contractor fails to complete all items of works within the period(s) of completion as stipulated in the aforesaid tender or any extended period (not due to the fault of the contractor) as may be agreed he shall without prejudice to any other right or remedy of the Authority on account of such default, pay compensation (not by way of penalty) at the rate of  $\frac{1}{2}$  % (half percent) per week on the total value of the contract subject to a maximum of 10% of the total value of the contract.

36.2 Should however, the contractor achieve the completion of the entire works as a whole under the contract within the time or in the extended time (not due to reasons of default on the part of the contractor) as may be accorded, the Authority will refund to him the amount of compensation recovered from him, if any, in respect of delay in the non completion of works(s) under the individual group/sub-group, as aforesaid in full, In this regard, the decision of the Engineer-in-Charge shall be final and binding.

36.3 The amount of compensation may be adjusted, withheld, deducted or set off against any sum due or payable to the contractor under this or any other contract with the Authority

36.4 All sums payable by way of compensation under any of the conditions will be considered as reasonable compensation without reference to the actual loss or damage, which will have been sustained.

36.5 Payment of such damages shall not relieve the contractor of his obligation to complete the work or from any other of his obligation or liabilities under the contract.

#### **CLAUSE – 37 : INSPECTION AND APPROVAL**

37.1 All works involving more than one process shall be subject to examination and approval at each stage thereof and the contractor shall give due notice to the Engineer-in-Charge on his authorized representative, when each stage is ready. In default of such notice, the Engineer-in-Charge shall

be entitled to appraise the quality and extent thereof and the decision of the Engineer-in-Charge in this regard shall be final and binding.

- 37.2 No work shall be put out of view without the approval of the Engineer-in-Charge or his authorized representative and the Contractor shall afford full opportunity for examination. The contractor shall give due notice to the Engineer-in-Charge or his authorized representative whenever any such work is ready for examination and the Engineer-in-Charge or his representative shall, without unreasonable delay, unless he consider it necessary and advise the contractor accordingly, examine and measure such work. In the event of the failure or the contractor to give such notice, he shall if required by the Engineer-in-Charge, uncover such work at the contractor's expenses.
- 37.3 Periodic inspection will be carried out by the EIC or his representative by their vessels. The contractor can have the inspection schedules finalized with the Engineer-in-charge. Generally all attempts should be made to have joint inspection and number of inspections be not less than three in a calendar month.

#### **CLAUSE – 38 : COMPLETION CERTIFICATE**

- 38.1 The work shall be completed to the entire satisfaction of the Engineer-in-Charge and within the specified time limit and terms and conditions of the contract. As soon as the work under the contractor is completed as a whole the contractor shall give notice of such completion to the Engineer-in-Charge. The Engineer-in-Charge shall inspect the work and shall satisfy himself that the work(s) has been completed in accordance with the provisions of the contract and then issue to the Contractor a certificate of completion indicating the date of completion. Should the Engineer-in-Charge notice that there are defects in the works or the works are not considered to be complete, he shall issue a notice in writing to the Contractor to rectify / replace the defective work or any part thereof or complete the work, as the case may be within such time as may be notified and after the contractor has complied with as aforesaid and gives notice of completion the Engineer-in-Charge shall inspect the work and issue the completion certificate in the same manner as aforesaid.
- 38.2 No certificate of completion shall be issued as stipulated above and no work be considered to be completed unless the contractor shall have removed from the work site and / or premises all his belongings / temporary arrangements brought / made by him for the site and / or premises in all respects and made the whole of the site and / or premises fit for immediate occupation / use to the satisfaction of the Engineer-in-Charge. If the contractor fails to comply with the above mentioned requirements on or before the date of completion of the work, the Engineer-in-Charge, may as he thinks fit and at the risk at cost of the contractor, fulfill such requirements and remove / dispose of the contractor's belongings / temporary arrangements, as aforesaid, and the contractor shall have no claim in this respect except for any sum realised by the sale of Contractor's belongings / temporary arrangements less the cost of fulfilling the said requirements and any other amount that may be due from the contractor. Should the expenditure on the aforesaid account exceed the amount realised by sale of such contractor's belongings / temporary arrangements then the contractor shall on demand pay the amount of such excess expenditure.

## **CLAUSE - 39 : MEASUREMENTS**

- 39.1 The Engineer-in-charge shall expect as otherwise stated ascertain and determine by measurement the value of work done in accordance with the contract.
- 39.2 Notwithstanding any provision in the relevant standard method of measurement or any general or local custom, measurement of work done under the contract shall be taken in accordance with the procedure set forth in the Technical Specifications or Schedule of Quantities under the contract. In case of items of work which are not covered by the Technical Specifications or Schedule of Quantities measurement shall be taken in accordance with the relevant standard methods of measurement laid down by the Bureau of Indian Standard.
- 39.3 All items having a financial value shall be entered in daily log book/ measurement book prescribed by the Authority so that the complete work performed under the contract is duly accounted.
- 39.4 Measurement shall be taken jointly by the Engineer-in-Charge or his authorised representative and by the contractor or his authorised representative.
- 39.5 Before taking measurements of any works, the Engineer-in-Charge or representative deputed by him for the purpose, shall give a reasonable notice to the Contractor. If the Contractor fails to attend or send an authorised representative for measurement after such notice or fails to countersign or to record the objection within a week from the date of taking the measurements, taken by the Engineer-in-Charge shall be taken to be correct and final measurements of such works.
- 39.6 The contractor shall, without extra charge, provide assistance with every appliance, labour and other things necessary for measurement.
- 39.7 Measurements shall be signed and dated by both parties each day on the Site on completion of measurement. If the contractor objects to any of the measurement recorded by the representative of the Engineer-in-Charge a note to the effect shall be made in the item objected to and such note shall be signed and dated by both parties engaged in taking the measurement. The decision of the Engineer-in-Charge on any such dispute or difference or interpretation shall be final and binding on the contractor in respect of all contract items, substituted items, extra items and deviations.

## **CLAUSE – 40: PAYMENT ON ACCOUNT**

- 40.1 Interim bills shall be submitted by the contractor monthly on or before the date fixed by the Engineer-in-Charge for the items of work completed. The Engineer-in-Charge shall then arrange to have the bills verified with reference to the measurements recorded in the measurement book(s).
- 40.2 Payment on account for amount admissible shall be made by the Engineer-in-Charge certifying the sum to which the contractor is considered entitled by way of interim payment for the work executed, after deducting therefrom the amount already paid, the security deposit and such other amounts as may be withheld, deductible or recoverable in terms of the contract.

- 40.3 Payment of the contractor's bills shall be made by the Authority only in Indian Rupees within 30 days from the date of submission of the bill subject to the acceptance of the Engineer-in- Charge.
- 40.4 Payments due to the contractor shall be made by crossed cheque by the Engineer-in-Charge or his authorised representative. Such cheques shall be issued direct to the contractor on furnishing a stamped receipt for the amount of the cheque or to his constituted attorney duly authorised to receive such payments from the EIC.
- 40.5 Any interim certificate given relating to work done or materials delivered may be modified or corrected by any subsequent interim certificate or by the final certificate. No certificate(s) of the Engineer-in- Charge supporting an interim payment shall itself be conclusive evidence that any work or materials to which it relates is / are in accordance with the same.
- 40.6 Should there be a request for extension of date of completion, pending its consideration interim payments shall continue to be made as provided herein.
- 40.7 TDS at the applicable rates shall be deducted at source from any payment made to the contractor against this contract.

**CLAUSE – 41 : TAXES, DUTIES AND LEVIES ETC.**

- 41.1 The prices shall include all the taxes, levies, cess, octroi, royalty, excise service tax or any other local or central taxes as applicable/ charged by Center or State Government on all materials, including steel, wood, POL (and increase if any, on these during the currency of the contract) that the contractor has to purchase for the performance of the contract, shall be payable by the contractor and the Authority will not entertain any claim for compensation whatsoever in this regard. The rates quoted by the contractor shall be deemed to be inclusive of all such taxes, duties, levies, etc.

**CLAUSE-42 : TAX DEDUCTION AT SOURCE**

- 42.1 TDS at the applicable rate as per Income Tax Act/Rules shall be deducted from all the payment/advances made against the contract.

**CLAUSE – 43 : PAYMENT OF FINAL BILL**

The final bill shall be submitted by the contractor within one month from the date of completion of the work or of the date the certificate of completion furnished by the Engineer-in-Charge. No further claim in this regard unless as specified herein under shall be entertained. Payment shall be made within three months. If there shall be any dispute about any item or items of the work then the undisputed item or items only shall be paid within the said period of three months or six months, as the case may be. The contractor shall submit a list of the disputed items within thirty days from the disallowance thereof and if he fails to do so, his claim shall be deemed to have been fully waived and absolutely extinguished.

#### **CLAUSE - 44 : OVER PAYMENTS AND UNDER PAYMENTS**

- 44.1 Whenever any claim whatsoever for the payments of a sum of money to the Authority arises out of or under this contract against the contractor, the same may be deducted by the Authority from any sum then due or which at anytime thereafter may become due to the contractor under this contract and failing that under any other contract with the Authority or from any other sum whatsoever due to the contractor from the Authority or from the Authority or from his security deposit, or he shall pay the claim on demand.
- 44.2 The Authority reserves the right to carry out post- payment audit and technical examination of the final bill including all supporting vouchers, abstracts, etc. The authority further reserves the right to enforce recovery of any over payment when detected notwithstanding the fact that the amount of the final bill may be included by one of the parties as an item of dispute before an arbitrator appointed under clause 48 of this contract and notwithstanding the fact that the amount of the final bill figures in the arbitration award.
- 44.3 If as a result of such audit and technical examination any over payment is discovered in respect of any work done by the contractor or alleged to have been done by him under contract, it shall be recovered by the Authority from the contractor by any of all of the methods prescribed above, and if any under payment is discovered, the amount shall be duly paid to the contractor by the Authority.
- 44.4 Provided that the aforesaid right of the Authority to adjust over-payment against amount due to the contractor under any other contract with the Authority shall not extend beyond the period of two years from the date of payment of the final bill or in case the final bill is a MINUS bill, from the date the amount payable by the Contractor under the MINUS final bill is communicated to the contractor.
- 44.5 Any sum of money due and payable to the Contractor (including the security deposit returnable to him) under the contract may be withheld or retained by way of lien by the Engineer-in-Charge or Authority against any claim of the Authority or such other person or persons in respect of payment of a sum of money arising out of or under any other contract made by the contractor with the Engineer-in-Charge or Authority or with such other person or persons. The sum of money so withheld or retained under this clause by the Engineer-in-Charge or Authority will be kept withheld or retained as such by the Engineer-in- Charge or Authority or till his claim arising out of in the same contract or any other contract is either mutually settled or determined by the arbitrator, if the contract is governed by the arbitration clause under the clause 48 or by the competent court hereinafter provided, as the case may be, and the contractor shall have no claim for interest or damages whatsoever on this account or any other ground in respect of any sum of money withheld or retained under this clause.

#### **CLAUSE - 45 : CONTRACT MATTERS TO BE TREATED AS CONFIDENTIAL**

- 45.1 All documents, correspondence, decisions and orders concerning the contract shall be considered as confidential and/or restricted in nature by the contractor and he shall not divulge or allow access to them by any un-authorized person.

45.2 The contractor shall take necessary steps to ensure that all persons employed on any work in connection with this contract have noted that the Indian Official Secrets Act, 1923 (XIX of 1923) applies to them and shall continue so to apply even after the execution of such under the contract.

**CLAUSE – 46 : FINALITY CLAUSE**

It shall be accepted as an inseparable part of the contract that in matters regarding materials, workmanship, removal of improper work, interpretation of the contract drawings and contract specifications, mode of procedure and the carryout out of the work the decision of the Engineer-in-Charge which shall be given in writing shall be final and binding on the contractor.

**CLAUSE – 47 : SUM PAYABLE BY WAY OF COMPENSATION TO BE CONSIDERED IS REASONABLE WITHOUT PREFERENCE TO ACTUAL LOSS**

All sum payable by way of compensation to the Authority under any of these conditions shall be considered as reasonable compensation without reference to the actual loss or damage sustained and whether or not damage shall have been sustained.

**CLAUSE – 48: ARBITRATION**

48.1 Except as otherwise provided herein before, all questions, disputes or difference in respect of which the decision has not been final and conclusive arising between the Contractor and the Authority in relating to or in connection with contract shall be referred for arbitration in the manner provided as under and to the sole arbitrator appointed as follows:

- (i) Either of the parties may give to the other notices in writing of the existence of such question dispute or difference.
- (ii) Within thirty (30) days of receipt of such notice from either party the engineer-in-charge of work at the time of such dispute shall send to the Contractor panel of three persons and there after the Contractor within fifteen (15) days of receipt of such panel communicate to the Engineer-in-charge the name of one of the persons from such panel and such a person shall then be appointed as sole arbitrator by the Chairman, IWAI. However, the arbitration so appointed shall not be an officer or the employee of Inland Waterways Authority of India.
- (iii) Provided that if the Contractor fails to communicate the selection of a name out of the panel so forwarded to him by the Engineer-in-charge then after the expiry of the aforesaid stipulated period the Chairman, shall without delay select one person from the aforesaid panel and appoint him as the sole arbitrator.

48.2 The arbitrator to whom the matter is originally referred being transferred or vacating his office or being unable to act for any reason, then the Chief Engineer shall appoint another person to act as sole arbitrator, such person shall be entitled to proceed with the reference from the stage at which it was left by the predecessor.

- 48.3 The award of the Arbitrator shall be final and binding. The Arbitrator shall decide in what proportion the Arbitrator's fees, as well as the cost of Arbitration proceeding shall be borne by either party.
- 48.4 The Arbitrator with the consent of the parties can enlarge the time, from, time-to-time to make and publish his award.
- 48.5 A notice of the existence in question, dispute or difference in connection with the contract unless served by either party within 30 days of the expiry of the defects liability period, failing which all rights and claim under this contract shall be deemed to have been waived and thus forfeited and absolutely barred.
- 48.6 The Arbitrator shall give reasons for the award if the amount of claim in dispute is Rs. 75,000/- and above.
- 48.7 The work under this Contract shall continue during Arbitration proceedings and no payments due from or payment by the Authority shall be withheld on account of such proceedings except to the extent which may be in dispute.
- 48.8 The arbitration and conciliation Act 1996 with any statutory modifications or re-enactment thereof and the rules made there under and being in force shall apply to the Arbitration proceedings under this clause.

**NOTE:** In case of contract with another public Sector Undertaking, following Arbitration Clause shall apply: "Except as otherwise provided, in case of a contract with a public Sector Undertaking if at any time any question dispute or difference whatsoever arises between the parties upon or in relation to, or in connection with this agreement, the same shall be settled in terms of the Ministry of Industry, Department of Public Enterprises O.M No.3/5/93-PMA dt.30.06.93 or any modifications / amendments thereof. "The arbitrator shall have the power to enlarge the term to rate the award with the consent of the parties provided always that the commencement or continuation of the arbitration proceeding shall not result in cessation or suspension of any of other rights and obligations of the parties of any payments due to them hereunder.

- 48.9 The parties to the agreement hereby undertake to have recourse only to arbitration proceedings under for Arbitration Act 1996 and the venue of the arbitration proceeding shall be GUWAHATI and the parties will not have recourse to Civil Court to settle any of their disputes arising out of this agreement except through arbitration.

**CLAUSE – 49: VALIDITY OF TERMS & CONDITIONS:**

- 49.1 The parties agree that if any term or provision of this contract is declared by a Court of competent jurisdiction to be illegal or in conflict with any law, the validity of the remaining terms and provisions shall not be effected and the right and obligations of the parties shall be construed and enforced as if this contract did not contain the particular term or provision held to be invalid.

\*\*\*\*\*

## PART- III

### TECHNICAL AND SPECIAL CONDITIONS

**1. Approach road (WBM/Brick soling on edge) linkage between active areas of DGPS station to the gate and the link road.**

At present the identified DGPS station has connectivity with a state link road that is connected to the National Highway. The land area taken over by IWAI is adjacent to the river and is sloping towards the river. The entire area is subjected to heavy rain and water logging. To avoid walking on slushy mud, it is considered necessary to link the active areas of the DGPS station with the main gate and the link road through a water bound macadam road or by a brick on edge soling road as per provision. However before laying of road the requisite defined area have to be filled up with earth and compacted as per specifications.

**(i) Earthwork In Embankment**:- Before commencement of work the area should be marked by pegs as directed by the Engineer In Charge, curves properly laid out, the top and bottom edges of the excavations and the toe of all the embankments and spoil banks clearly lock spitted. A complete profile should be set up on every 20m of distance and at every change of section. This profile should be a 3m length of the actual completed embankment. The seat of the embankment should be prepared to receive the new earth and for which the whole site must be cleared of all trees, roots, shrubs, grass. All loose surface or soft soil should be removed to about 15cm depth and the surface roughed by ploughing or digging all over. Small key trenches should be dug out in the bed to unite the body of the new embankment to the sub – soil.

All earthen embankments should be thrown up in layers not exceeding borrow pits of 30cm stretching right across the whole section. In banking side layers of 15 to 20 cm thickness and each layer should be slightly concave towards the centre. Each layer should be rolled well until all clods are flattened. The width of each layer should be a little in excess of the width required by the cross-section of the bank

Compaction improves the properties of the soil. To achieve high density the soil should be compacted in thin layers (15 to 20 cm ).

Rolling should commence at the edges and progress towards the centre except in super elevated portions where it should proceed from the inner edge to the outer. The number of passes required of a roller to give compaction. Each layer shall be compacted by rolling with 8 to 10 tonnes power road roller and a sheep foot roller if required.

In the preparation of sub grade and earthen shoulders the site is cleared and weak spots corrected and rolled. To check the spreading of aggregate beyond the carriageway or to provide confinement to the loose aggregate while compacting by rolling. The sub grade and earthen shoulder shall be consolidated with a Power Road Roller of 8 to 10 tonnes the roller shall run over the Sub Grade till the soil is evenly consolidated and behaves as an elastic mass (the roller shall pass a minimum of 5 runs on the sub grade. All undulations in the surface that develop due to rolling shall be made good with material or quarry spoils as the case may be and the sub grade is re rolled.

## 2. **Construction of boundary wall all around the DGPS station area and Steel Gate:-**

Provision is also made for boundary wall all around the terminal area for safety / security of DGPS area. The construction of boundary wall shall be as per specification or as directed by E-I-C.

### **i) Erection of Steel Gates:-**

#### **Fabrication works:**

**General:** (a) Supply of materials: All structural material for fabrication shall be supplied by the contractor.

(b) Fixing of structural in masonry/concrete work : Fixing of structural in masonry / concrete work shall include placing the structure in position and in line and level during the masonry/concrete work or cutting pockets or chases in masonry / concrete work for fixing the structure or leaving such pockets and chases during masonry/concrete work and grouting these pockets and chases in cement concrete, 1:2:4, with 12 to 6 graded trap aggregate.

In case of fixing these members to structural members. The cost is inclusive of welding or bolting the members to the existing structure, as per direction of the Engineer-in-charge.

(c) Welding: Welding shall be done by the electric process. The welding sequence, either for shop welding or site welding, shall be as indicated in the drawing, or as directed by the Engineer. Before welding, the members shall be first brought together and spot welded. All welding work shall be done by a qualified welder. All operations connected with welding and cutting equipment shall conform to the safety requirements, and all safety appliances shall be used during the process of welding.

The structures may be single, or of built up sections. The structures shall be so stacked at site as to avoid rusting. All assembly marks shall be thoroughly checked before taking up the erection work. Structures shall be hoisted and erected in position carefully without causing damage to other buildings or men working in the vicinity. The method of hoisting shall be as approved by the Engineer, but such approval; shall not relieve the Contractor from his responsibility for the work being carried out in a safe manner.

**(ii) Earthwork Excavation in foundation:-** This shall include all work involved in excavation, dressing of soil, shorting, filling around foundation and disposal of residual earth at a place. Boring and sub – surface data regarding nature of soil, sub soil water etc. shown on drawings. All excavations for construction of R. C. foundations shall be kept free of water till completion of foundations and substructure.

Foundation trenches shall dug out to the exact width of foundation concrete and the side shall be vertical. Excavated earth shall not be placed within 1m (3') of the edge of the trench.

The bottom of foundation trenches shall be perfectly leveled both longitudinally and transversely. The side of the trench shall be dressed perfectly vertical from bottom up to the least thickness of loose concrete may be laid to the exact width as per design. After the concrete has been laid masonry had been constructed the remaining portion of the trenches shall be filled up with earth in layer of 15cm and watered and well rammed.

**Back filling:-** Earth used for filling shall be free from salts, organic or other foreign matter. Material for back filling shall be obtained from the spoil of excavation. The filling operation

shall consist of laying the earth in layers not more than 15cm thick each, compaction it by rolling with sheep foot rollers.

**(iii) P. C. C. Work** :- This specification deals with cement concrete, plain for general use and covers the requirements for concrete materials. Aggregate shall be inert and should be clean, dense, hard, durable, non absorbent and capable of developing good bond with mortar. Coarse aggregate shall be hard broken stone of granite or similar stone, free from dust, dirt, and organic matters. The stone ballast shall be of 20mm. Fine aggregate shall be of coarse sand consisting of hard, sharp and angular grains and shall pass through screen of 5mm square mesh. Sand shall be of standard specifications clean and free from dust, dirt, and organic matters. Cement shall be fresh Portland cement of standard I.S.I. specifications , and shall have the required tensile and compressive stresses and fineness.

Water shall be clean and free from alkaline and acid matters and suitable for drinking purpose. The proportion of concrete shall be 1:2:4 as cement: sand: stone: ballast by volume unless otherwise specified, 1:3:6, 1:4:8 etc. proportion of concrete are used for weak concrete. For weak concrete brick ballast or cheap type stone ballast of 40mm size may be used.

**Machine mixing:** Stone ballast of required grade, sand and cement shall be put into the cement concrete mixer to have the required proportion. For concrete of 1:2:4 proportion first 4 boxes of stone ballast, then 2 boxes of sand and then 1 bag of cement shall be put in to the C. C. Mixer. The machine shall then be revolved to mix materials dry and then water shall be added gradually to the required quantity, 25 to 30 liters per bag of cement to have the required water cement ratio.

**Curing:** After about 2 hours laying when concrete has begun to harden, it shall be kept damp by covering with wet gunny bags or wet sand for 24 hours, and then cured by flooding with water making mud walls 7.5 cm high or by covering with wet sand or earth and kept damp continuously for 15 days.

**(iv) R.C.C. work (1:2:4):-** Steel reinforcing bars shall be of TMT bar( above 6mm diameter) / mild steel for 6mm dia. of standard specifications and shall be free from corrosion. The steel bar shall be round and capable of being bent without fracture. Cement concrete shall be of 1:2:4 proportion by volume for slabs, beams, columns and lintels unless otherwise specified. Cement, sand and coarse aggregate shall be same as for cement concrete in P. C. C. work. Centering and shuttering shall be made with timber. Centering and shuttering should not be removed before 14 days in general.

Mixing and curing are same as P. C. C. work.

**Water:** Water shall be clean, fresh and free from organic or other deleterious matters in solution or in suspension in such amounts that may impair the strength or durability of the concrete. Potable water is generally satisfactory.

**Measurement of Reinforcement:** Measurements will be taken for the actual quantity of steel used including overlap as per standard norms and no allowance will be given for wastage. Steel reinforcements shall be measured and paid for on the basis of theoretical standard weights of different sizes of bars irrespective of actual weight.

**(v) Shuttering work:-** Shuttering shall include all centering and form work required to support the concrete or masonry during the process of laying, compacting and setting. Shuttering shall be strong and rigidly constructed, so that there may not be any deformation under weight and pressure of wet concrete, constructional loads, wind and other forces. Shuttering shall be either

of wooden planking, preferably thick, 20mm, with or without plywood facing or steel sheet lining or of steel plates stiffened by steel angles, or plywood boards.

**Form work: Shuttering for concrete and masonry work :-**

The term “ Shuttering” shall include all centering and form work required to support the concrete or masonry during the process of laying, compacting and setting , and all items such as planking, lagging , walling, moulds, voves, cross bearers, struts, props and bracings, shall be covered by the term.

Shuttering shall be strong and rigidly constructed, so that there may not be any deformation under weight and pressure of wet concrete, constructional loads, wind and other forces. It shall be true to line, level. Shape and dimensions. Shuttering shall be constructed in such a manner , that it can be easily removed afterwards.

The shuttering shall have a smooth and even surface and be so constructed as to remain sufficiently rigid during the placing and compacting of concrete and shall be sufficiently tight to prevent loss of liquid from the concrete.

Devices shall be provided in the shuttering for forming openings, holes, pockets, chases, recesses, etc., where required. Cutting of holes, etc. in the concrete after casting shall be avoided. Corner fillets shall be provided in the form work to obtain chamfered edges to beams, columns, etc., wherever required, and the rate quoted shall be inclusive of such work.

If materials on which concrete or mortar is likely to stick are used for shuttering, a smearing of oil shall be given on the faces of the shuttering in contact with the concrete or mortar. Care shall be taken that oil does not come in contact with the reinforcement. Forms should be cleaned from all dust and loose materials before applying oil over it. Shuttering made of absorbent material like bricks, shall be thoroughly wetted before laying concrete or masonry. Form work with brick lining may be done for structures below G. L. and on earth face with prior permission of the Engineer. In such cases, the brick lining may be left in position.

Shuttering shall be either of wooden planking, preferably thick. 20mm, with or without plywood facing or steel sheet lining or of steel plates stiffened by steel angles, or plywood boards.

The shuttering shall be such that after its removal, the exposed concrete surface shall be smooth and even. If any uneven off and plastered with 6mm thick cement plaster 1.4. No extra payment shall be made for this.

**Minimum period for striking shuttering or forms :**

1. Walls, columns, vertical sides of beams and sides of foundations.....24 to 48 hrs., as may directed by the EIC.
2. Slabs (props. Left under) ..... 3 days
3. Beam soffits (props left under) ..... 7 days
4. Removal of props to slabs
  - a) Spanning up to 4.5m ..... 7 days
  - b) Spanning over 4.5 m ..... 14 days
5. Removal of props for beams & arches

a) Spanning up to 6m	.....	14 days
b) Spanning over 6m	.....	21 days

In any case, prior permission of the Engineer shall be obtained before removal of any shuttering. If, for any reason, the Engineer considers it necessary to keep the shuttering for periods longer than those specified above, the contractor shall comply with the same, in such cases, no extra payment shall be made.

The removal of shuttering shall be carried out in such a manner, that the concrete or masonry is not damaged in any way or its strength affected.

Payment shall be made on the shuttered area of concrete surface in square metres. The measurement shall be taken correct to cm. Extra payment shall not be made for making holes in the shuttering for fixing dowel bars, fan hooks etc.

**(vi) Brick work:-** All bricks shall be of first class of standard specifications. Mortar shall be of standard specifications. Proportion of cement sand mortar should be 1:4. bricks should be fully soaked in clean water before use. No damaged or broken bricks shall be used. Mortar joints shall not exceed 6mm in thickness and joints shall be fully filled with mortar. Brickwork shall be carried not more than 1m height at a time.

The brickwork shall be kept wet for a period of at least 10 days after laying. Necessary and suitable scaffolding shall be provide to facilitate the construction of brick wall.

**(a) Scope:** This specification covers the construction of brick masonry in foundations, arches, walls etc. at all elevations. Only masonry with first class burnt clay brick is dealt with in this section.

Provision of the latest revision of IS:2212 shall be complied with unless permitted otherwise and any other IS codes( latest revision) shall form a part of this specification to the extent it has been referred to or applicable with this specification.

**(b) Material:** Bricks shall conform to the requirements of IS:1077. Specification for common burnt clay building bricks and shall be subclass B 75.

Bricks shall be of uniform deep red, cherry or copper colour, thoroughly burnt, without being vitrified regular in shape and size and shall have sharp and square sides and edges and parallel; faces to ensure uniformity in the thickness of the courses of brick work.

Bricks shall be free cracks, chips, flaws, stone or lumps of any kind. They shall not show any signs of efflorescence either dry or subsequent to soaking in water.

Bricks shall be sound, hard, homogenous in texture and emit clear ringing sound on being struck.

Bricks shall be of the local standard size. Any other similar size may be accepted but no dimension shall vary more than 3mm from the accepted size.

All bricks which absorb water more than 20<sup>0</sup> of their own dry weight after immersed in water for 24 hours shall be rejected.

All bricks shall have to be approved by the Engineer in charge. Any lot of bricks found not up to the specification must be removed from the site immediately at contractor's own cost.

Bricks shall be carefully and systematically stacked at locations as directed in an approved manner. Each stack shall contain equal number of bricks preferably not more than 3000.

(c) **Water :** Water shall be clean and free from deleterious matter such as oil, acid, alkali, salt and vegetable growing.

(d) **Cement:** Portland cement conforming to Indian Standard Specification IS:269 shall be used. It shall be of approved manufacture, the name of which shall be submitted to the Engineer In charge for approval. Cement shall be stored in weather proof sheds on dry platforms and protected from rain and moisture. Cement which has set or partially set shall not be used.

(e) **Mortar:** Mortar for brickwork in wall shall be 1 part cement and 4 parts sand by volume.

The unit of measurement for cement shall be a bag of cement weighting 50 kg and this shall be taken as 0.035 cu. metre. Other ingredients in specified proportions shall be measured in boxes of suitable size. Sand shall be measured on the basis of its dry volume. In case of damp sand its quantity shall be increased suitably to allow for bulkage.

Cement and sand shall be mixed dry thoroughly on clean approved platform and water shall then be added to obtain a mortar of the consistency of a staff paste, care being taken to adjust sufficient water for the purpose.

Mortar shall be used as soon as possible after mixing and within 2 hours after the cement is mixed we. Mortar unused for more than 2 hours shall be rejected and removed from the site.

(f) **Sand:** Sand shall conform to IS : 383 100% of the same shall through I.S. Sieve No. 240 and not more than 15% to 35% through I.S. Sieve No. 30. Sand shall be clean and free from dirt, clay or other impurities.

Percentage of clay or total impurities shall not be more than 5% by weight.

(g) **Curing and protection:** Masonry during and after construction shall be kept moist and cured properly as per IS Codes or as directed by the Engineer Incharge. The brickwork shall be kept moist for a period of atleast 10 days.

(h) **Workmanship:** All workmanship shall be of best standard as approved by the Engineer Incharge.

**Laying:** Bricks shall be soaked in water before use for atleast six (6) hours. The contractor shall provide tanks of sufficient capacity to allow the specified immersion. Bricks shall be laid in water by hand and not thrown. The bricks shall not be too wet at the time of use as they are likely to slip on the mortar bed and there will be difficulty in ensuring plumbness of the wall. Bricks shall be laid with a shore joint in full mortar beds and thoroughly slushed up with mortar at every course. Pace bricks shall be laid on full mortar beds and have all vertical joints completely filled with mortar. All brickwork shall be plumb, square and true to dimensions shown on drawings and in approved bond.

All brickwork shall be built tightly against columns, floor slabs or other structural parts around window and door frames with proper distance to permit caulked joint. Where drawings indicate that structural steel column and spandrel beams are to be partly or wholly covered with brickwork, the bricks shall be built closely against all flange and webs with all spaces between the steel and the brickwork filled solid with setting mortar with not less than 10mm in thickness.

Bricks shall be laid in joints not more than 12mm thick where stucco finish is specified, the joints of brick work shall be raked to a minimum depth of 10mm to ensure good bond of stucco with brickwork.

**(vii) Plastering :** The materials of mortar, cement and sand or lime, as specified should be of standard specifications. The plastering should be applied 20 mm thick in two coats in internal plastering work. For internal & external plastering 1:3 cement mortar with sand is used. External plastering shall be started from top and worked down towards floor. The first and second coat of plastering shall be kept damp for at least two days. Internal plastering shall be started wherever the building frame is ready and centering of the roof slabs have been removed. In external plastering work, the plastering should be applied 15 mm thick in two coats. 20 mm thick cement plastering on ceiling in two coats shall be completed before starting off wall plaster.

Curing shall be started as soon as the plaster has hardened sufficiently not to be damaged when watered. The plaster shall be kept wet for at least 10 days.

**(a) Scope:** This specification covers the plastering work on brick / stone masonry or concrete faces of specified thickness with architectural features wherever necessary. The code of practice for application of cement lime plaster finishing IS:1661 latest revision shall be applicable in so far as it is applicable.

**(b) Mix:** Mortar for plastering in the proportion as specified on drawing specification, shall be mixed in a dry state and then wetted and mixed thoroughly to obtain the required consistency. The mortar shall be mixed in an approved manner including machine mixing if desired by the Engineer Incharge and in batches so that the mortar is consumed within half an hour of mixing. Any mortar for plaster which is partially set shall be rejected and removed from site.

**(c) Application:** Before application of plaster surface is to be prepared conforming to IS: 1661 – latest revision.

In all plaster work, mortar shall be applied with somewhat more than the required thickness and well pressed in to the joint and in the surface and rubbed and leveled with a flat wooden rule to give required thickness.

Plaster when more than 15mm thick, shall be applied in two coats base coat followed by the finishing coat. Thickness of base coat shall be just sufficient to fill up all unevenness in the surface, no single coat, however, shall exceed 12mm in thickness. The undercoat shall be thicker than the upper coat. The overall thickness of the plaster shall not be less than the minimum thickness shown in the drawings. The under coat shall be allowed to dry and shrink before applying the second coat of plaster.

The undercoat shall be cratched or roughened before it is fully hardened to form a mechanical key. The method of application shall be ‘thrown on’ rather than ‘applied by thrown’. The finished surface shall be true to line and plumb, and the contractor shall without any extra cost to the company make up any irregularity in the masonry / concrete work with plaster. The mortar shall adhere to the surface intimately when set and there should be no hollow sound when struck.

All vertical edges of pillars, door jambs etc. shall be chamfered or rounded off as directed by the Engineer Incharge. All corners must be finished to their true angles or rounded. Any plastering that is damaged shall be repaired and left in good condition at the completion of the job without any extra cost to the company.

**(d) Curing:** All plastered surfaces after laying and sufficiently hardened shall be kept wetted for a minimum period of seven days and shall be protected from excessive heat and sunlight by suitable approved manner.

**(viii) Painting Work :** The surface shall be made perfectly smooth by rubbing with sand paper before painting. All holes and open joints should be filled with strong putty and smoothed by rubbing with sand paper. The number of coats shall be as specified in new work one priming coat and two coats of paints shall be applied. Each coat shall be perfectly dry before the next is applied.

In steel work, all rust and scales shall be perfectly removed by scrapping and brushing. In steel work exposed to weather, the painting should be done either with red oxide paint or with aluminum paint.

In wood painting knots, holes, cracks, etc. shall be filled and covered with putty. The woodwork shall be rubbed down with sand paper sufficiently smooth to remove any grain marks. The priming coat shall be applied with brushes on new wood based surfaces up to 100 mm in width. All primer coats shall be compatible to the material of the surface to be finished as well as to the finishing coats to be applied.

All steel and iron surfaces in addition shall be free from rust. Enamel paint shall be applied on properly primed surface; subsequent coat shall not be applied till the previous coat is dry. The two coats of approved brand enamel paint shall be applied on new wood or wood based surface.

The painting of exterior and interior wall will be carried out as specified in BOQ of the same item of works.

**(ix) Electrical works :-**

All Electrical Works are to be carried out as per Standard Specification. All materials of electrical items should be ISI marks. All such materials shall be made by reputed recognized manufacturers and shall be approved by the Engineer In charge or his representative.

**(x) Sanitary Work :-**

All sanitary fittings are to be carried out as per Standard Specification and as per BOQ. All materials of sanitary items should be ISI marks. All such materials shall be made by reputed recognized manufacturers and shall be approved by the Engineer In charge or his representative.

**2. Special Conditions :-**

(a) The contractor should submit a tentative programme of working within 7 days of the date of start of work. The contractor will adhere to work as per programme of the department. No claim whatsoever will be entertained on this account.

(b) Unless otherwise provided in the Schedule of quantities, the rates tendered by the contractor shall be all inclusive and shall apply to all heights lifts and leads and depths and nothing extra shall be payable to him on this account.

(c) The drawings shall at all times be properly correlated before executing any work. However, in case of any discrepancy in the item given in the Schedule of quantities appended with the tender and drawings relating to the relevant item, the former shall prevail unless and otherwise given in writing by the Engineer-in-Charge.

- (d) The contractor shall be required to produce samples of all materials and fittings sufficiently in advance to obtain approval of the Engineer-in-Charge.
- (e) The contractor shall make his own arrangements for obtaining electric connections. If required and make necessary payments directly to the department concerned.
- (f) No payment shall be made to the contractor for any damage caused by rain, floods or any other natural cause whatsoever during the execution of work. The damage to work will be made good by the contractor at his own cost, and no claim on this account shall be entertained.
- (g) Other agencies may also simultaneously execute the works like electrification, horticulture or external services and other works at the same site along with this work in particular. The contractor shall afford necessary facilities for the same. No claim in the matter shall be entertained.
- (h) Some restrictions may be imposed by the security staff etc. on the working and/or movement of labour, materials etc, the contractor shall be bound to follow all such restrictions/instructions and nothing extra shall be payable on this account.
- (i) (a) The works will be carried out in the manner complying in all respects with the requirements of relevant byelaws of the local body under the jurisdiction of which the work is to be executed or as directed by the Engineer-in-charge and nothing extra will be paid on this account.  
(b) The contractor shall comply with proper and legal orders and directions of the local or public authority or municipality and abide by their rules and regulations and pay all fees charges which he may be liable.
- (j) The contractor shall take all precautions to avoid all accidents by exhibiting necessary caution boards day and night, speed limit boards, red flags, red lights and providing barriers. He shall be responsible for all damages and accidents caused due to negligence on his part. No hindrance shall be caused to traffic during the execution of the work.
- (k) The contractor shall be responsible to arrange at his own cost all necessary tools and plants required for execution of the work.
- (l) The contractor shall provide at his own cost suitable weighing and measuring arrangements at site for checking the weight/dimensions as may be necessary for execution of the work.
- (m) Rate for all items in which use of cement is involved inclusive of charges for curing.
- (n) The foundation trenches shall be kept free from water while all the works below ground level are in progress.  
All the materials used for this work will be of standard quality as per various ISI before commencement of work.
- (o) Royalty at the prevalent rates whenever payable shall have to be paid by the contractor on the boulders, metal, shingle, sand and bejri etc. or any other material collected by him for the work direct to the revenue authority of the District/States Government concerned.
- (p) The rate for all items of work, shall, unless clearly specified otherwise include cost of all labour, material and other inputs used during involved in the execution of the item.
- (q) The surplus excavated earth which is beyond the requirement of Government work may be allowed by the E.I.C. to be disposed off by the contractor on his own or to sell the surplus earth of to private parties at his discretion but nothing extra will be paid for carriage or disposal of surplus earth of the same is not required on any Govt. work.

- (r) The work shall be executed and measured as per metric dimensions given in the schedule of quantities, drawings etc. (F.P.S. units wherever indicated are for guidance only).
- (s) Wherever any reference to any Indian standard specification occurs in the documents relating to this contract the same shall be inclusive of all amendment issued their to or revisions there of if, any, up to the date of receipt of tenders.
- (t) The rates for different items of work shall be for all heights and depths of the buildings except where other wise specified in the item of work.
- (u) Contract matters are to be treated as confidential.
- (v) All documents, correspondence, decisions and orders concerning the contract shall be considered as confidential and or restricted in nature by the contractor and he shall not divulge or allow access to them by any un authorized person.
- (w) The contractor shall take necessary steps to ensure that all persons employed on any work in connection with this contract have noted that the Indian official secrets act 1923 (XIX of 1923) applies to them and shall continue so to apply even after the execution of work under the contract.

**3. Deployment of Manpower for safety & security :**

The contractor is responsible for the safety & security of all the Govt. property laying at during the excavation of work. The contractor is also responsible for any injury/loss of life of the personnel deployed by him during the excavation of work.

## LIST OF ACCEPTABLE MATERIAL

### CIVIL WORK

Sr. No.	Name of Material	Make/ Brand Name
1.	Cement	Birla, J.K., L&T, ACC
2.	Cold Twisted Bar	SAIL, Rathi, Kamdhenu
3.	Ceramic Glazed Tile	NITCO, Orient, Somany, Kajaria
4.	White Cement	J.K., Birla
5.	Dry Distemper	Castle (British Paints), Diamond (Shalimar Paints), Super Jenson (Jenson & Nicholson), Murason (Garware Paints)
6.	Synthetic Enamel Paint	Speclite (Asian Paint), Luxell (British Paint), Narolac (Goodless Narolac), Superlac (Shalimar Paints), Barolac (Jenson & Nicholson).
7.	Water Proofing Cement Paint	Super Snowcem (Killick Nixon), Durocem (British Paint), Comekot (Shalimar Paint), Rubbiancem C. Jenson & Nicholson India Ltd.

### STEEL WORK

1.	Locks	Godrej, Prima, Plaza
2.	Section Steel	SAIL, Jindal, Tata steel

### SANITARY AND WATER SUPPLY

1.	Sanitary Ware	Parry Ware/ Hind Ware, Cera
2.	C.P. Fitting	Parko, Zim, Gem
3.	Mirror	Modi, Atul
4.	C.I. Pipe & Fittings	NECO, RIF
5.	G.I. Pipe 'B class'	Jindal, Prakash
6.	Ball Valve	Leader, Sant, Parag
7.	PVC Tank	Sintex, Policon,

### ELECTRICAL (All material shall be ISI marked)

1	Electric wire	Plaza, Delton, Ecko, Setia
2	Switch, sockets	Anchor
3	MCB	Havels, MDS, Standard, Indo Kopp
4	Ceiling fans	Crompton Greaves, Orient, Usha, Bajaj
5	Luminaries	Philips, Crompton Greaves, Bajaj

## **SPECIAL CONDITIONS**

### **A. HOLD HARMLESS:**

- i) The Contractor should indemnify and hold the Authority harmless from any liability or claim for damages because of bodily injury, death, property damage, sickness, disease or loss and expense arising from the Contractor's performance of this Contract.
- ii) The Contractor is acting in the capacity of an independent contractor with respect to the Authority.
- iii) The Contractor should protect, defend and indemnify the Owner from any claims by labourers or Sub Contractors for unpaid work or labour performed in connection with this Contractor.

### **B. CHANGE ORDERS:**

- i) The Contractor should not make any changes in the schedule of work or the Specifications without written authorization by the Engineer in Charge and written concurrence by the Authority.

### **C. UNSATISFACTORY PERFORMANCE:**

- i) In case of unsatisfactory performance/ progress / services by the Contractor, IWAI shall have the right to issue a show cause notice to the consultant requiring him to explain the reason thereof.
- ii) In case of continuation of such unsatisfactory performance / progress / services, IWAI reserves the right to rescind the Contract and get the balance work executed at the risk and cost of the Contractor.

### **D. WARRANTIES:**

- i) The Contractor should warrant that this contract does not and shall not infringe any existing or subsequent patents, rights or licenses of any third party.
- ii) The Contractor should further warrant that the rights of the Authority under the present contract are not and shall not be infringed by any prior or subsequent contract, which may have been or may hereafter be entered into by the Contractor with any other party.

### **E. MISCELLANEOUS:**

- i) The Contract embodies the entire understanding of the parties as to its subject matter and shall not be amended except in writing executed by both the parties and subject to the approval of the concerned authorities.

## PART-IV

### BILL OF QUANTITY

**Construction of various civil works like foundation of whip antenna, coil hut, land development, drainage, boundary wall etc. on National Waterways No-2 (River Brahmaputra) for DGPS station at Silghat, Assam**

#### **Earth work in filling**

SI No	Particulars of item.	Unit	Quantities	Rate (Rs)	Amount (Rs)	Remarks
1	Earth work in filling with approved material by EIC/his representative obtained from borrow pits with initial lead up to 3 Km and lift 1.5m transporting to site, spreading, loading and unloading including compaction.	Cum	5760			
	<b>TOTAL =</b>	<b>Cum</b>	<b>5760</b>			

#### **Construction of Boundary wall**

SI No	Particulars of item.	Unit	Quantities	Rate (Rs)	Amount (Rs)	Remarks
1	Earth work in excavation for foundation trenches of walls, retaining walls, footings of column, steps, septic tank etc. including refilling (return filling) the quantity as necessary after completion of work, breaking clods in return filling, dressing, watering and ramming etc. and removal of surplus earth with all lead and lifts as directed and specified in the following classification of soils including bailing out water where necessary as directed and specified.	cum	144			
2	Providing plain cement concrete work in Boundary wall 7 Columns of in proportion 1:3:6	cum	20.16			
3	Brick Masonry work of boundary wall and curing etc complete					
	i) Full brick work (CM 1:6)	Cum	96.60			

	ii) Half brick work (CM 1:4)	Sqm	540			
4	Providing and laying reinforced cement concrete works in prop 1:2:4	Cum	40.95			
5	15mm thick plaster in single coat in CM 1:3	Sqm	1350			
6	Supplying, fitting and fixing in position reinforcement bars conforming to relevant IS Code for RCC work.	Kg	3276			

### Construction of Deep Tubewell, water supply etc.

Sl. No.	Particulars of item	Unit	Qty.	Rate (Rs)	Amount (Rs)	Remarks
1	Installation of Tubewell of 4"/2" size with submersible pump of 1 H.P.					
a	Cost of material viz					
i	PVC pipe	No	4"-10 Nos			
		No	2"-20 Nos			
ii	R/F	No	2"-8Nos			
iii	R/S	m	4"x2"-2m			
iv	Clamp	No	4"-2nos			
v	SOLVENT	gm	500gm			
vi	Tata pipe	Ft	1"-100ft			
vii	Cable wire	M	50m			
viii	Well Cover	no	4"x1"-2no			
ix	Clamp	no	1"-2 nos			
x	ELBOW	no	1'-2 nos			
xi	NIPPLE	no	1"x6"-5 nos			
b	Submergible pump with panel of 1 hp (varuna or Rigman make)	no	1			
c	Charges of well bore including the transportation of the materials and labour on daily wages all inclusive for total 300 ft boring for all type of soils	feet	300			
d	Red bajri for filling in the bore well after boring and placing the PVC pipe in the well	cum	20			
2	Providing and fixing over head water tank (Sitex etc) - 2 Nos of 500 ltrs capacity each and 2" PVC / GI pipes with tee & L as required fitted to the toilet and kitchen in Porta cabins with trial run for proper working of all the sanitary systems before handing over all complete.	LS				

## Construction of Coil Hut

Sl. No.	Particulars of item	Unit	Qty.	Rate (Rs)	Amount (Rs)	Remarks
1	<b>Earthwork in Excavation :</b>					
	Earth work in rough excavation, banking excavated earth in layers not exceeding 20 cm in depth breaking clods watering, rolling each layer with steel rammers, and lead up to 50 m and lift up to 1.5m.	cum	12.00			
2	Providing sand gravel in floor of Coilhut including carriage of material within 50 Km, dewatering, ramming etc. complete with payment of land compensasion forest Royalti, Sales tax and duties.	cum	2.07			
3	<b>Earthwork / sand filling :</b>					
a)	Earth filling in plinth in layers not more than 150mm thick including necessary carriage watering, ramming etc. complete as directed and specified including payment of land complication forest royalty, sales tax and other duties and taxes as may be necessary (a) with earth of silt or sand obtained by head load with lead upto 500 m and lift up to 1.5m	cum	5.524			
b)	Sand filling with river sand in trenches, plinth, sides of foundations etc. in layers not exceeding 20 cm in depth, consolidating each deposited layer by ramming and watering, lead up to 50 cm lift up to 1.5m.	cum	3.24			
4	<b>Plain cement concrete work :</b>					
a)	Providing and laying 25mm thick coarse aggregate of sizes 13mm to 32mm in foundation bed for footing steps as directed and specified including dewatering if necessary curing complete. (a) in prop. 1:3:6 deduct cable trench	cum	2.617			
b)	Providing and laying 40mm thick damp proof coars with cement concrete in prop. 1:1.5:3 with graded stone agg. Of 12.5 mm down nominal size including providing approved damp proof admixture in prop. As recommended by the manufacture including curing etc. complete as directed.	sqm	3.25			
5	<b>BRICK WORK :</b>					
a)	Brick work in cement mortar 1 <sup>st</sup> class bricks including racking out joints and dewatering if necessary and curing complete as directed in sub-structure up to plinth level & steps in Prop. 1:4	cum	7.612			

b)	Brick work in cement mortar 1 <sup>st</sup> class brick including racking out joints and curing complete as directed in superstructure above plinth level (a) in Prop. 1:4	cum	7.518		
6	<b>Reinforced cement concrete work :</b>				
a)	Providing and laying plain/reinforced cement concrete work in prop 1:2:4 including dewatering if necessary, and curing complete but excluding cost of form work and reinforcement for reinforced cement concrete work in floor, roof, lintel etc.	cum	2.75		
7	<b>Reinforcement (Steel work) :</b>				
	Supplying, fitting and fixing in position reinforcement bars conforming to relevant I.S. code for R.C.C. work/ R. B walling including straightening, cleaning, cutting and bending to proper shapes and length as per details, supplying and binding with 20G annealed black wire and placing in position with proper blocks, supports chairs spears etc. complete ISI approved – M.S. ROD,& TMT bar				
a)	TMT bar 12 and 10 mm dia	qtl	3.5		
b)	M.S. ROD 6 mm dia	qtl	0.41		
8	<b>Cement concrete Flooring :</b>				
	40 mm thick cement concrete floor consisting of 25 mm under layer of cement concrete in prop. 1:3:6 and 15 mm thick wearing layer in cement concrete in prop. 1:1:2 finished with a floating coat of neat cement finish using cement slurry for bond @ 2.75 kg/ sqm of floor area, wearing layer is to be laid in panels including curing etc.	sqm	9.00		
9	<b>Cement Plastering :</b>				
	15 mm cement plaster on the rough side of single or half brick wall of mix 1:4 (1cement : 4 fine sand)	sqm	84.00		
10	<b>Painting :</b>				
	Wall paint (two coats) with acrylic emulsion approved brand and manufacture (asian paint/Berger paint/ICI paint/ J & N paint/ nerolac) on new surface to give an even shade after troughly brushning the sufface free from mortar droppings and other foreign atter and sand papered smooth (a) Acrylic emulsion paint of approved brand and manufacture (asian paint/ Berger paint/ICI paint/ J& N paint/ Nerolac)	sqm	36.48		
11	<b>Waterproofing of Chajjas, Roof, and Slabs :</b>				

	Providing and applying over roof/raft slab, two coats of water proofing slurry prepared with cement, fine sand in prop 1:1 admixed with modified acryline polymer like cemflex of Silka india ltd. By brush @ 0.25% of cement-sand mixture (by weight) after proper surface preparation (surface preparation including through cleaning of surface to be measured and paid separately) as specification & direction by Deptt. complete.	sqm	25		
12	<b>Timber shuttering :</b>				
	Providing from work of ordinary timber planking so as to give a rough finish including centering, shuttering, strutting and propping etc., height of propping and centering below supporting floor to ceiling not in-situ reinforced concrete and plain concrete work in : - foundation footings bases of columns pilecap Using 25 mm thick plank	sqm	16		
13	<b>PCC for PLATFORM :</b>				
	Providing and laying plain cement concrete works in prop 1:2:4 including dewatering if necessary and curing complete but excluding cost of form work and reinforcement for reinforced cement concrete work, in Columns pillars, posts struts, lintal, balcony etc. including preparing the top surface and finishing of nosing.	cum	0.1		
14	Providing wood working in frames of door windows clerestory windows and other frames, wrought framed and fixed in position with second class teak wood.	cum	0.092		
15	Providing and fixing paneled or paneled and glazed shutters for door, windows and clerestory windows including ISI mark black enameled MS butt hinges with necessary screw excluding paneling which will be paid for separately – 35 mm thick shutters.	sqm	3.23		
16	Supply of mildsteel hook holdfest door-window formwork.	kg	15		
17	R.C.C. Jali work few thick in ventilations complete work including steel reinforcement and formwork.	sqm	0.405		
18	Painting of wood works in Chaukhat and Shutters.	sqm	7.47		
19	Coal tarring two coats at Chaukhats-	sqm	1.244		
20	Colour washing one coat over one coat of white washing	sqm	47.1		

21	Anti Termite treatment including the cost of chemical emulsion, diluting and injecting chemical emulsion along the external wall below concrete and floor or masonry apron using chemical emulsion @ 2.25 liter per linear meter including drilling and plugging holes etc with chlorpyriphos/Linden E.C. 20% with 1% concentration	sqm	12.25		
22	Precast terrazzo tiles 22mm thick with graded marble chips of size upto 12mm laid in floors, and landing, jointed with neat cement slurry mixed with pigment of match the shade of the tiles including rubbing and polishing complete with precast tiles on 20 mm thick bed of cement mortal 1:4 (1 cement : 4 coarse sand) Light shade using white cement	sqm	12.96		

### Foundation of Whip Antenna

Sl. No.	Particulars of item	Unit	Qty.	Rate (Rs)	Amount (Rs)	Remarks
<b>1</b>	<b>Earthwork in Excavation :-</b>					
	Earth work in rough excavation, banking excavated earth in layers not exceeding 20 cm in depth breaking, watering, rolling each layer with steel rammers, and to 50 m and lift up to 1.5m.	Cum	17.63			
<b>2</b>	<b>Earthwork / sand filling :-</b>					
	Earth filling in layers not more than 150mm thick including necessary carriage watering, ramming etc. as directed and specified including payment of land complication forest royalty, sales tax and other duties and taxes as may be necessary	Cum	11.71			
<b>3</b>	<b>Plain cement concrete work :-</b>					
	Providing and laying reinforced cement concrete work in prop 1:2:4 including dewatering if necessary, and curing complete including cost of form work and reinforcement for reinforced cement work in floor, roof, lintel etc.	Cum	1.73			
<b>4</b>	<b>Reinforced cement concrete work :-</b>					
	Providing and laying reinforced cement concrete work in prop 1:2:4 including dewatering if necessary, and curing complete including cost of form work and reinforcement for reinforced cement concrete work in floor, roof, lintel etc.	Cum	4.34			
<b>5</b>	<b>Reinforcement (Steel work) :-</b>					
	Supplying, fitting and fixing in position reinforcement bars conforming to relevant I.S. code for R.C.C. work/ R. B walling including straightening, cleaning, cutting and bending to proper shapes and length as per details, supplying and binding with 20Ga	Qtl	3.55			

6	Providing from work of ordinary timber planking so rough finish including cementing	Sqm	1.13			
---	---	-----	------	--	--	--

### **Fabrication of Iron gate**

Sl No	Particulars of item.	Unit	Qty	Rate (Rs)	Amount (Rs)	Remarks
1	Supplying, fitting and fixing double leaf heavy duty iron gate of size 2mx1.8m, frame made from 40mmx 40mm x 6mm M.S angle and with M.S flat of size 40mmx6mm size or as per approved design by E-I-C. Necessary locking arrangement on both faces, arrangement for temporary closing of gate and 3 nos (minimum) strong hinges of M.S bars and flat of same size on each leaf to be embedded in RCC pillars as necessary including two coat painting over one priming coat to all iron work as directed and specified	no	1	L.S.		

### **DRAINAGE WORK**

Sl No	Particulars of item.	Unit	Qty	Rate (Rs)	Amount (Rs)	Remarks
1.	Construction of Drain as per enclosed drawing.	mtrs	110			

### **INTERNAL ROAD**

Sl No	Particulars of item.	Unit	Qty	Rate (Rs)	Amount (Rs)	Remarks
1.	Brick Soling: Laying brick soling layer on prepared sub - grade with brick on end edging according to lines, graded and cross section shown on the drawing filling joints with sand and earth, spreading 25mm thick layer of earth over brick soling, watering and rolling the same as per technical specification	Sqm	330			

## CONSTRUCTION OF SEPTIC TANK

SI No	Particulars of item.	Unit	Qty	Rate (Rs)	Amount (Rs)	Remarks
1.	Earth work in excavation for foundation trenches of walls, retaining walls, footings of column, steps, septic tank etc. including refilling (return filling) the quantity as necessary after completion of work, breaking clods in return filling, dressing, watering and ramming etc. and removal of surplus earth with all lead and lifts as directed and specification including bailing out water where necessary as directed and specified.	Cum	27.5			
2	Providing and laying in position cement concrete of specified grade excluding the cost of centering and shuttering all work up to plinth level 1:3:6	Cum	3.05			
3	Brick work with FPS bricks of class designation 75 in foundation and plinth in cement mortar 1 : 4 ; 1 cement : 4 coarse sand)	Cum	7.05			
4	Reinforcement cement concrete work in walls (any thickness) including attached pilaster, buttress, plinth and string courses, filets column, pillors, piers, abutments, posts and struts etc up to floor five level excluding cost of centering, shuttering, finishing, and reinforcement. (1:2:4)	Cum	0.76			
5	15 mm thick cement plaster of mix 1 : 3	Sqm	22.00			
6	20 mm thick cement plaster in floor of mix 1 : 3	Sqm	6.00			
7	Iron footrest of 16 mm dia plain bar	No	5.00			
8	100 mm dia HCI pipe laying and jointing with 1 : 3 cement mortar	M	4.00			
9	PVC. Tee 110 mm dia with one leg of 63 cm	No	8.00			
10	HCI bend 100 mm dia	No	2.00			
11	50 mm dia PVC Venting pipe	M	7.00			
12	Providing , fitting and fixing 50 mm dia HCI Cowl with cement cahlking complete as directed and specified	Each	2.00			
13	Making soak pit of 1.50 x 1.50x1.50 m including earthwork in excavation of soil and then filling up of the trench with brick bats/ Charcoal covered with earth over a layer of AC plain Sheet above brick bat filling complete as per standard and direction of E-i-C	Cum	3.38			
14	Reinforcement	Qtl	2.81			

## PART - V

Annexure -I

### AGREEMENT FORMAT

This agreement made on \_\_\_\_\_day\_\_\_\_\_year\_\_\_\_\_between the Inland Waterways Authority of India (hereinafter called the 'IWAI' which expression shall unless excluded by or repugnant, to the context, be deemed to include heir, successors in office) on one part and M/S\_\_\_\_\_ (hereinafter called the 'CONTRACTOR' which expression, shall unless excluded by repugnant to the context be deemed to include his heirs, executors, Administrators, representatives and assigns of successors in office) on the other part.

WHEREAS THE IWAI desirous of undertaking the works for \_\_\_\_\_

---

WHEREAS the contractor has offered to execute and complete such works and whereas IWAI has accepted the tender of the contractor and WHEREAS the contractor has furnished \_\_\_\_\_ as security for the due fulfillment for all the conditions of this contract.

#### NOW IN THIS AGREEMENT WITNESSTH AS FOLLOWS

In this agreement words and expression shall have the same meaning as are respectively as assigned to them in the conditions of contract hereinafter referred to:

The following documents shall be deemed to form and be read and construed as part of this agreement VIZ.

- i) (a) Notice Inviting Tenders
- (b) Tender form
- (c) Warranty
- ii) Information & instruction for Tenders
- iii) (a) Schedule - Bill of Quantity
- (b) Annexure
- iv) General Conditions of Contract
- v) Technical and Special Conditions of Contract

The contract agreement has been compiled by the IWAI from the original tender documents and all the correspondences from the tendering stage till acceptance. In the event of any difference arising from the completion of the contract, the original tender documents, contractor's offer, minutes of

meetings and correspondence between the party ended vide letter No. \_\_\_\_\_ may be referred to by either party. These documents shall take precedence over the compiled documents.

The contractor hereby covenants with the IWAI to complete and maintain the “Works” in conformity in all respect, with the provisions of the agreement.

The IWAI hereby covenants to pay the contractor in consideration of such completion of works, the contract price at the time and in the manner prescribed by the contract.

IN WITNESS WHEREOF the parties hereunto have set their hands and seals on the day year first written.

For and on behalf of  
*(Inland Waterways Authority of India)*

For and on behalf of  
*Contractor*

*Signature* \_\_\_\_\_

*Signature* \_\_\_\_\_

*Name & Designation* \_\_\_\_\_

*Name & Designation* \_\_\_\_\_

*Stamp*

*Stamp*

Witness:

Witness:

1) Signature \_\_\_\_\_

1) Signature \_\_\_\_\_

2) Name & Designation \_\_\_\_\_

2) Name & Designation \_\_\_\_\_

**BANK GUARANTEE PROFORMA FOR FURNISHING  
PERFORMANCE GUARANTEE**

**To  
The Chairman  
Inland Waterways Authority of India  
A-13, Sector-1  
Noida - 201301**

In consideration for the Chairman, Inland Waterways Authority of India hereinafter called ‘the Authority’ having agreed, under the terms and conditions of the Agreement dated ..... made between..... and ...for the due fulfillment of the said Agreement by the Contractor of the terms and conditions contained in the said Agreement, on production of Bank Guarantee for Rs..... (Rupees.....) at the request of..... Contractor(s), We (Bank) do hereby undertake to pay to the Authority an amount not exceeding Rs..... against any loss or damage caused to or suffered, or would be caused to or suffered by the Authority by reason of any breach of the said Contractor(s) of any of the terms or conditions contained in the said Agreement.

2. We..... do hereby undertake to pay the amount due and payable under this Guarantee without any demur, merely on a demand from the Authority stating that the amount claimed is due by way of loss or damage caused to or would be caused to or suffered by the authority by reason of breach by the said contractor(s) of any of the terms or conditions contained in the said Agreement or by reason of the contractor(s)’s failure to perform the said Agreement,. Any such demand made on the Bank shall be conclusive as regards the amount due and payable by the Bank under this guarantee. However, our liability under this guarantee shall be restricted to an amount not exceeding Rs.....

3. We undertake to pay the authority any money so demanded notwithstanding any dispute or disputes raised by the contractor(s) / suppliers(s) in any suit or proceeding pending before any court or Tribunal relating thereto liability under this present being absolute and unequivocal.

The payment so made by us under this Bond shall be valid discharge of our liability for payment there under and the contractor(s) / supplier(s) shall have no claim against us for making such payment.

4. We, ..... further agree that the guarantee herein contained shall remain in full force and effect during the period that would be taken for the performance of the said Agreement and that it shall continue to be enforceable till all the dues of the Authority under or by virtue of the said Agreement have been fully and its claim satisfied or discharge or till..... Certify that the terms and conditions of the said Agreement have been fully and properly carried out by the said Contactor(s) and accordingly discharges this Guarantee after..... years from the date of completion of the said contract unless a demand or claim under this Guarantee is served in writing on the bank but before the expiry of the said period of ..... years in which case it shall be enforceable against the bank not withstanding the fact that the same is enforced after the expiry of the said period of ..... years.

5. We,.....further agree with the Authority that the Authority shall have the fullest liberty without our consent and without affecting in any manner our obligations hereunder to vary any of

the terms and conditions of the said Agreement or to extend time of performance by the said Contractor(s) from time to time or to postpone for any time or from time to time any of the powers exercisable by the Authority against the said Contactor(s) and to forbear or enforce any of the terms and conditions relating to the said Agreement and we shall not be relieved from our liability by reason of any such variation, or extension being granted to the said Contractor(s) or for any forbearance, act or omission on the part of the Authority or any indulgence by the Authority to the said Contractor(s) or by any such matter or thing whatsoever which under the law relating to sureties would, but for the provision, have effect of so relieving us.

6. It shall not be necessary for the Authority to proceed against the Contractor before proceeding against the Bank and the Guarantee herein contained shall be enforceable against the Bank notwithstanding any security which the Authority may have obtained or obtain from the Contactor shall at the time when proceedings are taken against the Bank hereunder be outstanding or unrealized.

7. Notwithstanding anything contained herein above our liability under the guarantee is restricted to Rs..... and shall remain in force until..... Unless a claim or suit under this guarantee is filed with us on or before..... ALL OUR RIGHTS UNDER THE GUARANTEE SHALL BE FORFEITED and the bank shall be relieved and discharged from all liabilities therein.

8. This Guarantee will not be discharged due to the change in the constitution of the Bank or the Contractor(s) / supplier(s).

9. We,..... lastly undertake not to revoke this Guarantee during its currency except with the previous consent of the Authority in writing.

Dated the .....date of.....2006  
for.....  
(indicate the name of Bank)  
Signature.....  
Name of the Officer.....  
(in Block Capitals)  
Designation of  
Code No.....  
Name of the Bank and Branch.

**DETAILS OF BANK ACCOUNT FOR RELEASE OF PAYMENT THROUGH ELECTRONIC  
FUND TRANSFER SYSTEM**

**(TO BE FURNISHED BY THE BIDDER ON IT'S LETTER HEAD)**

**NAME OF THE PROJECT:** \_\_\_\_\_

**THE BANK ACCOUNT DETAILS ARE FURNISHED AS BELOW:**

We \_\_\_\_\_ (Name of the Bidder) hereby request you to give our payments by crediting our bank account directly by E-Payment mode as per account details given below. We hereby undertake to intimate IWAI in case of any change in particulars given below and will not hold IWAI responsible for any delay / default due to any technical reasons beyond IWAI's control:-

**Bank Account Number** : \_\_\_\_\_

**RTGS/NEFT/IFSC CODE** : \_\_\_\_\_

**Name of the Bank** : \_\_\_\_\_

**Address of the Branch of the Bank** : \_\_\_\_\_

**Branch code** : \_\_\_\_\_

**Account Type** : \_\_\_\_\_  
**(Saving/Current/Others)**

**A BLANK CHEQUE (CANCELLED) IS ENCLOSED HEREWITH.**

I/We hereby declare that the particulars given above are correct and complete. If the transaction is delayed or credit is not affected at all for reasons of incomplete or incorrect information, I/We would not hold IWAI responsible.

Date:

Signature of Authorized Signatory

**BANK CERTIFICATION:**

It is certified that above mentioned beneficiary holds a bank account No. \_\_\_\_\_  
with our branch and the bank particulars mentioned above are correct.

Date:

Authorized Signatory

Authorization No. \_\_\_\_\_

Name: \_\_\_\_\_

Official Seal/Stamp

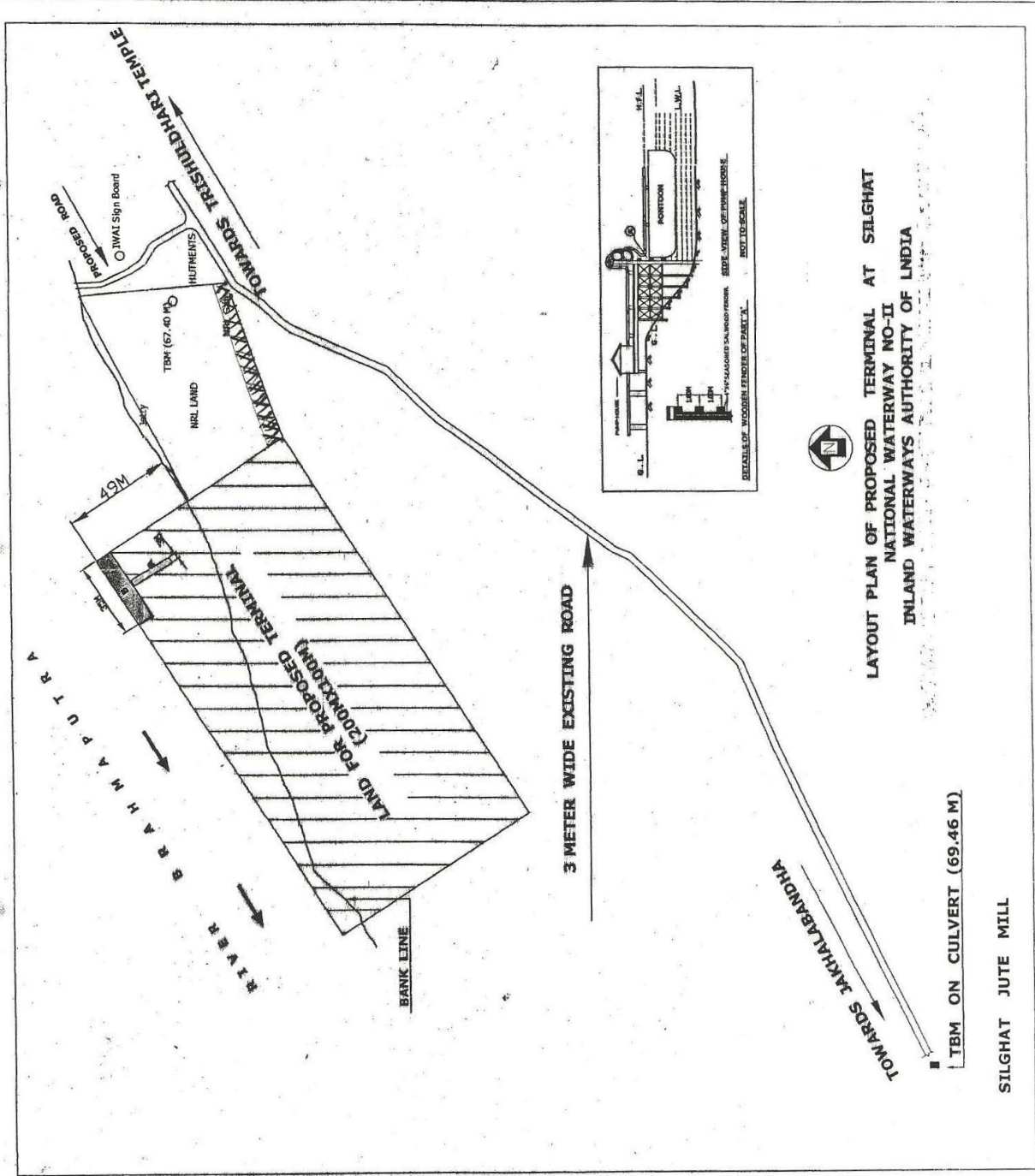

LAYOUT PLAN OF PROPOSED TERMINAL AT SILGHAT  
 NATIONAL WATERWAY NO-II  
 INLAND WATERWAYS AUTHORITY OF INDIA

TBM ON CULVERT (69.46 M)

SILGHAT JUTE MILL

DETAILS OF FOUNDATION FOR CONSTRUCTION OF BOUNDARY WALL AT SILGHAT ON NW-2

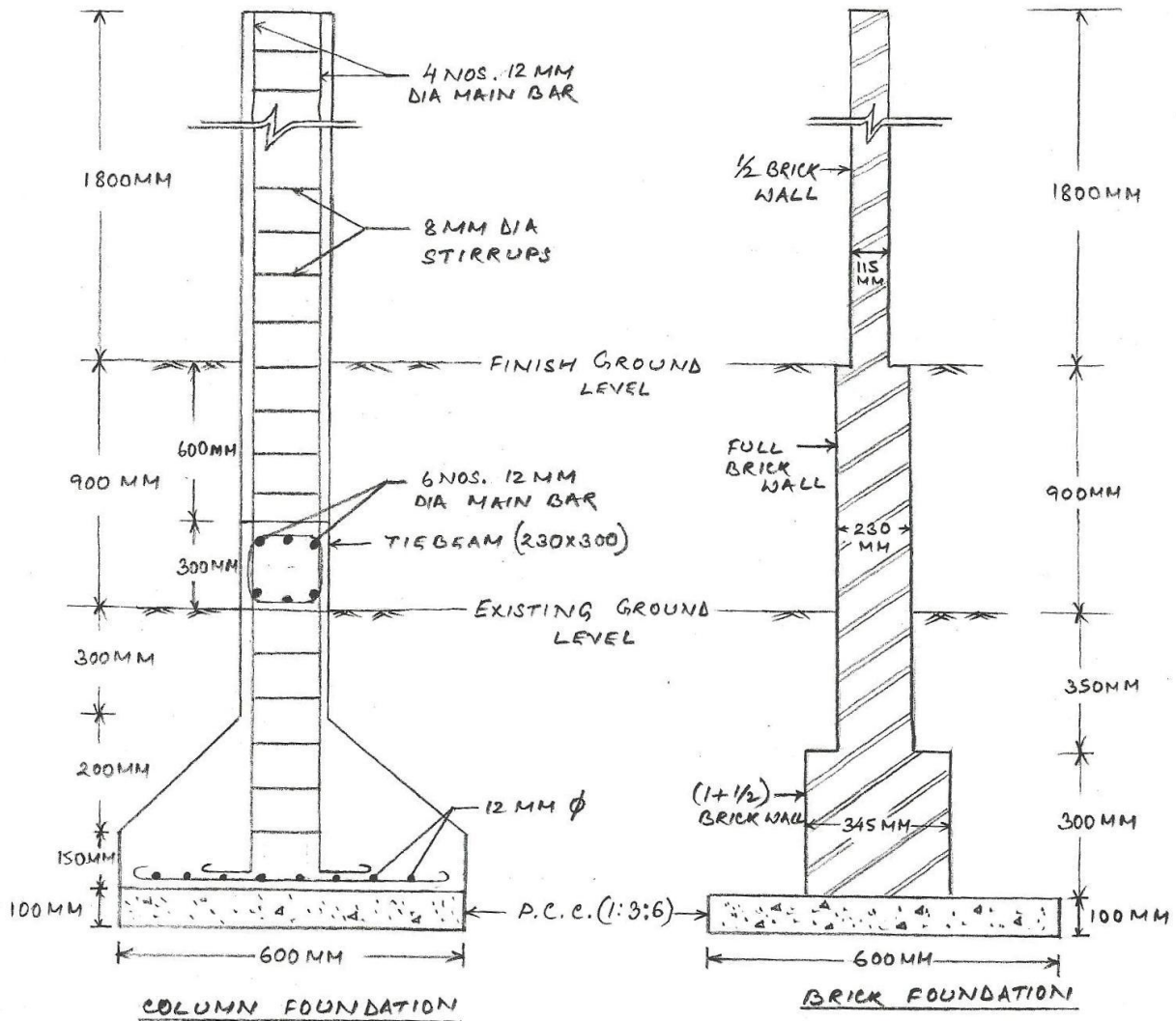

NOTE: NOT TO SCALE

COLUMN SIZE = (230x230)  
TIE BEAM = (230x300)

**DRAINAGE WORK INSIDE DGPS AREA (DRAWING NOT TO SCALE)**

